

DICHTUNGSSATZ KPL. 600.30.099.000  
ENTHÄLT DICHT.SATZ ZYL.KOPF 600.30.097.000  
GASKET-SET CPL. 600.30.099.000  
INCL. GASKET-SET CYL. HEAD 600.30.097.000

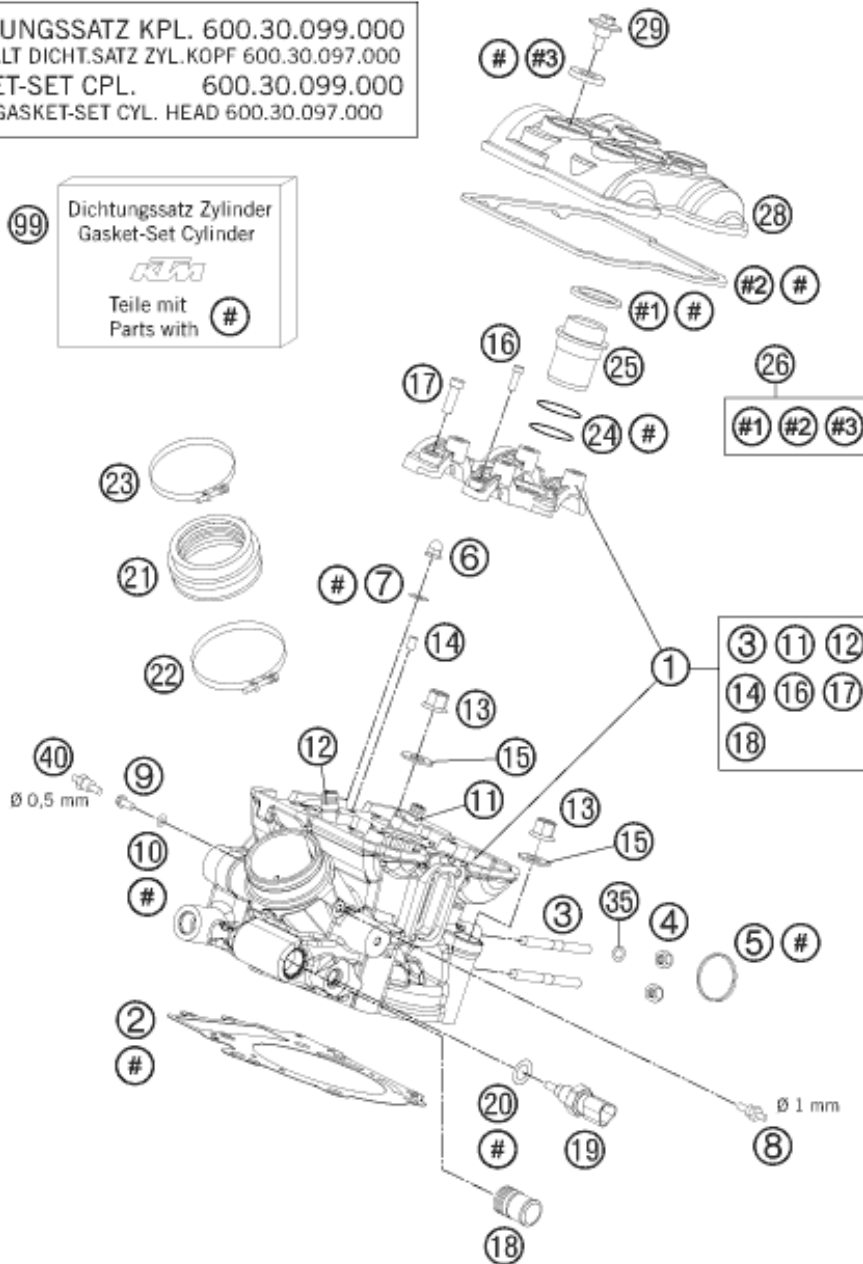

| Pos | Part Number   | Description                    | Additional Text | Quantity |
|-----|---------------|--------------------------------|-----------------|----------|
| 1   | 6013612014423 | CYLINDER HEAD REAR CPL.        |                 | 1.00     |
| 2   | 60030036000   | CYLINDER HEAD GASKET 0,5 101MM |                 | 1.00     |
| 3   | 0835080165    | STUD M 8X16 10.9               |                 | 2.00     |
| 4   | 51010086100   | self-locking nut M8 Cu         |                 | 2.00     |
| 5   | 61005005000   | Exhaust gasket 05              |                 | 1.00     |
| 6   | 61230045000   | CAP NUT M6 STAINLESS STEEL     |                 | 2.00     |
| 7   | 0125060003    | WASHER DIN0125-A 6,4           |                 | 2.00     |
| 8   | 61036023100   | VACUUM CONECTION 2006          |                 | 1.00     |
| 9   | 0025060106    | HH collar screw M6x10 TX30     |                 | 1.00     |
| 10  | 0603061001    | CU-SEAL RING DIN7603-6X10X1    |                 | 1.00     |
| 11  | 60036026101   | VALVE GIUDE EXHAUST            |                 | 2.00     |
| 12  | 60036025101   | VALVE GIUDE INTAKE             |                 | 2.00     |
| 13  | 60036078200   | hex collar nut M10 WS13        |                 | 4.00     |
| 14  | 0402050980    | needle roller DIN 5402 5x9.8   |                 | 2.00     |

|    |               |                               |                           |      |
|----|---------------|-------------------------------|---------------------------|------|
| 15 | 60036078050   | SHIM 10,2X19X1,5MM 05         |                           | 4.00 |
| 16 | 0912060255    | AH SCREW DIN0912-M 6X25 10.9  |                           | 4.00 |
| 17 | 0984080305    | AH SCREW DIN7984-M 8X30 10.9  |                           | 4.00 |
| 18 | 58030010200   | SCREW IN NOZZLE M20X1,5       |                           | 1.00 |
| 19 | 75035047000   | TEMPERATURE SENSOR WATER 07   |                           | 1.00 |
| 20 | 0770100020    | o-ring 10.00x2.00 silicone    | ONLY FOR LC4<br>ADVENTURE | 1.00 |
| 21 | 61036044000   | RUBBERSLEEVE INTAKE FLANGE 05 |                           | 1.00 |
| 22 | 61036048000   | HOSE CLAMP GEMI 66MM 05       |                           | 1.00 |
| 23 | 61036047000   | Hose clamp GEMI 63mm 05       |                           | 1.00 |
| 24 | 0770298178    | O-RING 29,87X1,78 VITON       |                           | 2.00 |
| 25 | 60136075100   | INSERT SPARK-PLUG SHAFT       |                           | 1.00 |
| 26 | 60036099000   | VALVE COVER GASKET SET FR+RR  |                           | 1.00 |
| 28 | 6003615210023 | VALVE COVER REAR              |                           | 1.00 |
| 29 | 60036052020   | collar screw M 6 WS=10 03     |                           | 4.00 |
| 35 | 0125080003    | washer DIN 125 A -8.4         |                           | 1.00 |
| 40 | 60036023100   | VACUUM CONECTION M6/0,5MM     | WITH 2 MARKING<br>GROOVES | 1.00 |
| 99 | 60030097000   | GASKET SET CYL. HEAD KPL. 03  | CYLINDER FRONT +<br>REAR  | 1.00 |