

DICHTUNGSSATZ KPL. 600.30.099.000
 ENTHÄLT DICHT.SATZ ZYL.KOPF 600.30.097.000
 GASKET-SET CPL. 600.30.099.000
 INCL. GASKET-SET CYL. HEAD 600.30.097.000

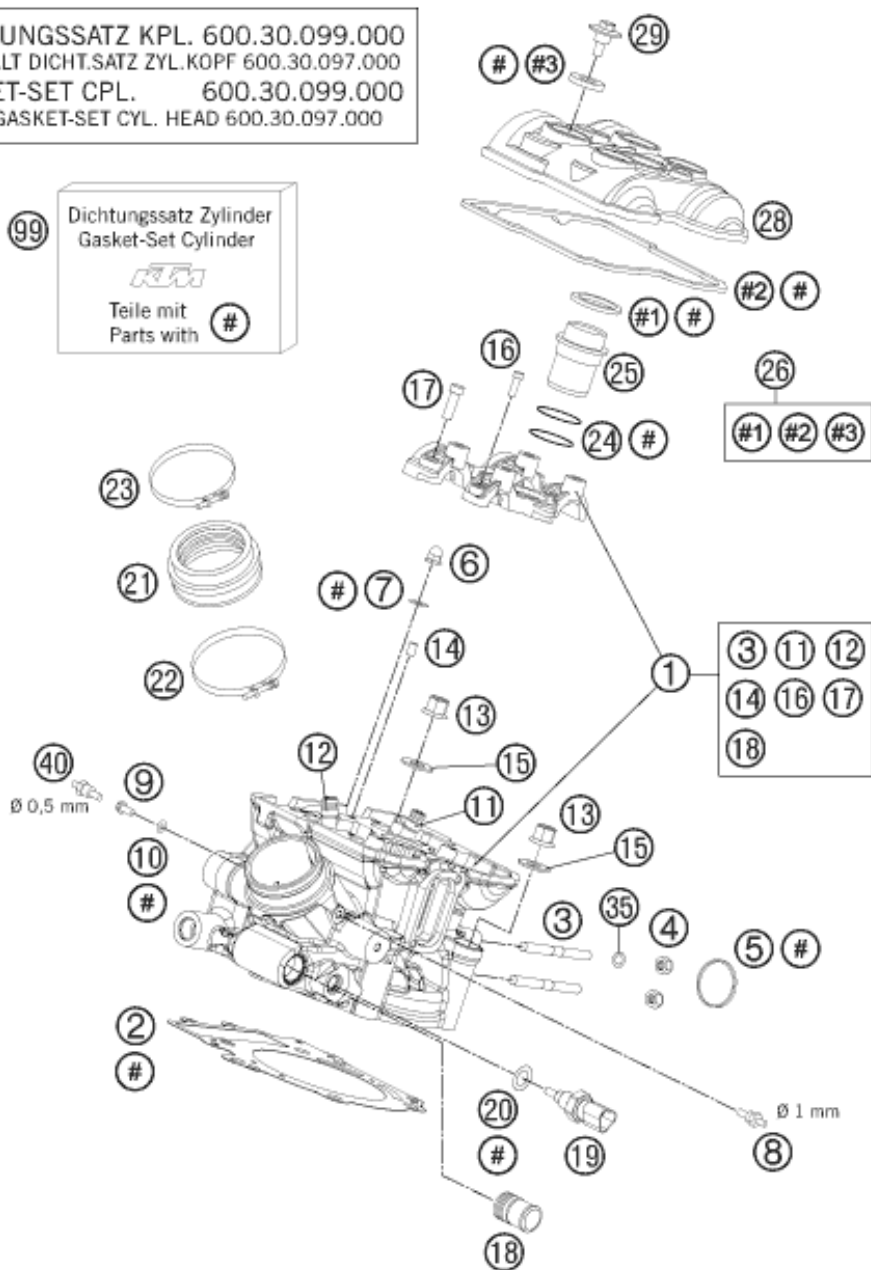

| Pos | Part Number | Description | Additional Text | Quantity |
|-----|---------------|--------------------------------|-----------------|----------|
| 1 | 6013612014423 | CYLINDER HEAD REAR CPL. | | 1.00 |
| 2 | 60030036000 | CYLINDER HEAD GASKET 0,5 101MM | | 1.00 |
| 3 | 0835080165 | STUD M 8X16 10.9 | | 2.00 |
| 4 | 51010086100 | self-locking nut M8 Cu | | 2.00 |
| 5 | 61005005000 | Exhaust gasket 05 | | 1.00 |
| 6 | 61230045000 | CAP NUT M6 STAINLESS STEEL | | 2.00 |
| 7 | 0125060003 | WASHER DIN0125-A 6,4 | | 2.00 |
| 8 | 61036023100 | VACUUM CONECTION 2006 | | 1.00 |
| 9 | 0025060106 | HH collar screw M6x10 TX30 | | 1.00 |
| 10 | 0603061001 | CU-SEAL RING DIN7603-6X10X1 | | 1.00 |
| 11 | 60036026101 | VALVE GIUDE EXHAUST | | 2.00 |
| 12 | 60036025101 | VALVE GIUDE INTAKE | | 2.00 |
| 13 | 60036078200 | hex collar nut M10 WS13 | | 4.00 |
| 14 | 0402050980 | needle roller DIN 5402 5x9.8 | | 2.00 |

| | | | | |
|----|---------------|-------------------------------|---------------------------|------|
| 15 | 60036078050 | SHIM 10,2X19X1,5MM 05 | | 4.00 |
| 16 | 0912060255 | AH SCREW DIN0912-M 6X25 10.9 | | 4.00 |
| 17 | 0984080305 | AH SCREW DIN7984-M 8X30 10.9 | | 4.00 |
| 18 | 58030010200 | SCREW IN NOZZLE M20X1,5 | | 1.00 |
| 19 | 75035047000 | TEMPERATURE SENSOR WATER 07 | | 1.00 |
| 20 | 0770100020 | o-ring 10.00x2.00 silicone | ONLY FOR LC4 ADVENTURE | 1.00 |
| 21 | 61036044000 | RUBBERSLEEVE INTAKE FLANGE 05 | | 1.00 |
| 22 | 61036048000 | HOSE CLAMP GEMI 66MM 05 | | 1.00 |
| 23 | 61036047000 | Hose clamp GEMI 63mm 05 | | 1.00 |
| 24 | 0770298178 | O-RING 29,87X1,78 VITON | | 2.00 |
| 25 | 60136075100 | INSERT SPARK-PLUG SHAFT | | 1.00 |
| 26 | 60036099000 | VALVE COVER GASKET SET FR+RR | | 1.00 |
| 28 | 6003615210023 | VALVE COVER REAR | | 1.00 |
| 29 | 60036052020 | collar screw M 6 WS=10 03 | | 4.00 |
| 35 | 0125080003 | washer DIN 125 A -8.4 | | 1.00 |
| 40 | 60036023100 | VACUUM CONECTION M6/0,5MM | WITH 2 MARKING GROOVES | 1.00 |
| 99 | 60030097000 | GASKET SET CYL. HEAD KPL. 03 | CYLINDER FRONT + REAR | 1.00 |