

ACHTUNG !!!
 Bei Bestellung von Getrieberädern, Markierung beachten.
CAUTION !!!
 When ordering transmission gears, check marking.

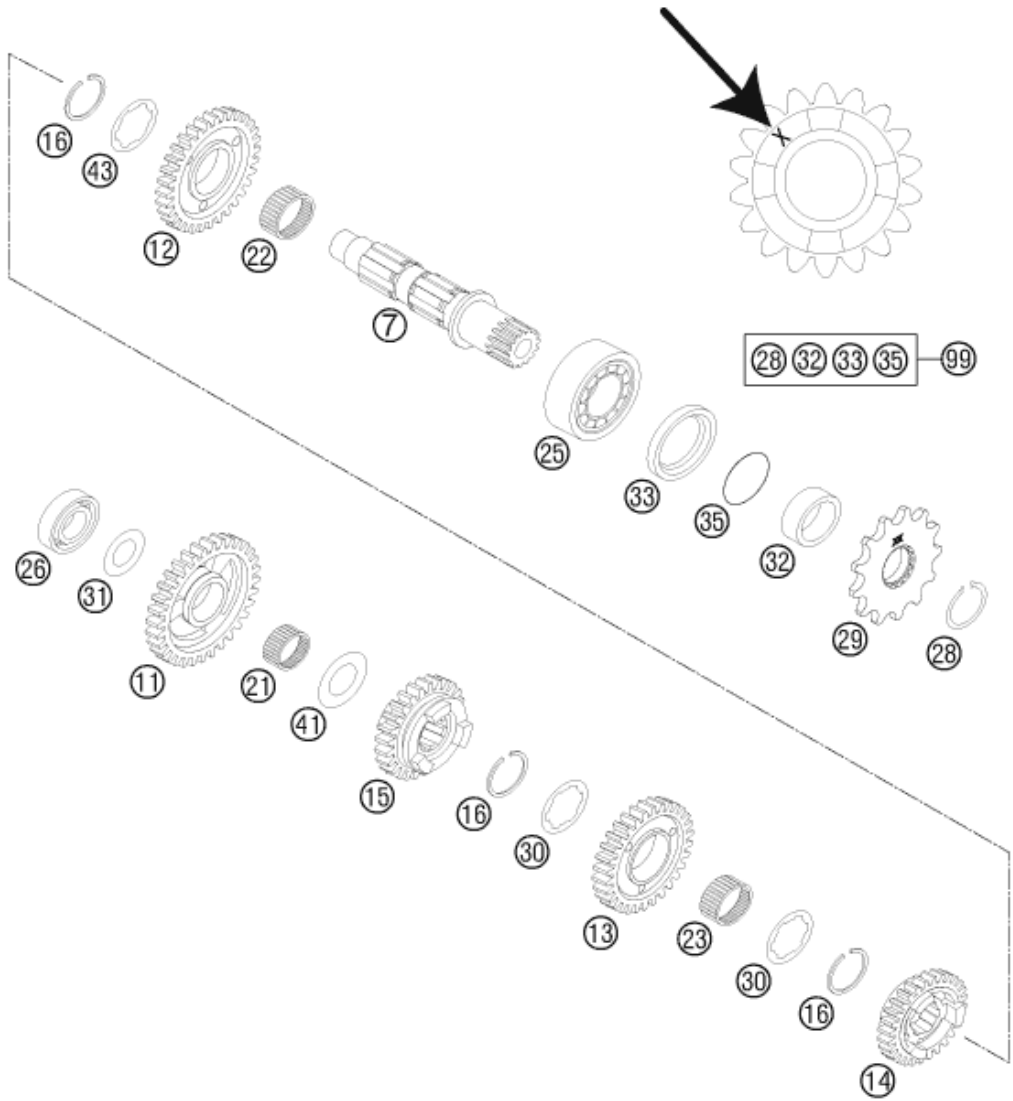

Pos	Part Number	Description	Additional Text	Quantity
7	54833007000	COUNTERSHAFT 2003		1.00
11	54833011000	IDLER GEAR 1ST G. 28-T"1S28"		1.00
12	54833012200	IDLER GEAR 2.G 24-Z "2S24"		1.00
13	54833013000	IDLER GEAR 3RD G. 24-T "3S24'		1.00
14	54833014000	SLIDING GEAR 4TH G.24-T "4S24		1.00
15	54833015000	SLIDING GEAR 5TH G.21-T "5S21		1.00
16	77033022000	AXIAL-CIRCLIP 25X1,65		3.00
21	0405202413	NEEDLE BEAR. K20X24X13		1.00
22	0405242812	NEDDLE BEAR. K24X28X11,9 DIV.		1.00
23	0405222613	NEEDLE BEAR. K 22X26X13 TN		1.00
25	54833025000	BALL BEARING TM-SC05C20C4 NTN		1.00
26	0625062035	BALL BEARING 6203 JR2 C3		1.00
28	52033096000	LOCK RING DIN0471-25X1,64SD		1.00
29	50033029013	FRONT SPROCKET 13-T		1.00

29	50033029014	FRONT SPROCKET 14-T		0.00
30	59033030000	STOP DISC 25,2X32X1,5		2.00
31	56033030000	STOP DISC 17,2X30X1		1.00
32	54833032011	spacer sleeve drive end		1.00
33	0760324571	SHAFT SEAL RING 32X45X7 BSLNBR		1.00
35	0770250020	O-RING 25,00X2,00 NBR 70		1.00
41	59033080000	Shim 20x31.9x1		1.00
43	50333043000	STOP DISC 25,2X32X1		1.00
99	00050000940	COUNTER SHAFT REP.KIT 2 STROKE		0.00