

**ACHTUNG !**  
Bei Bestellung von Getrieberädern, Markierung

**CAUTION !**  
When you order transmission gears, check ma

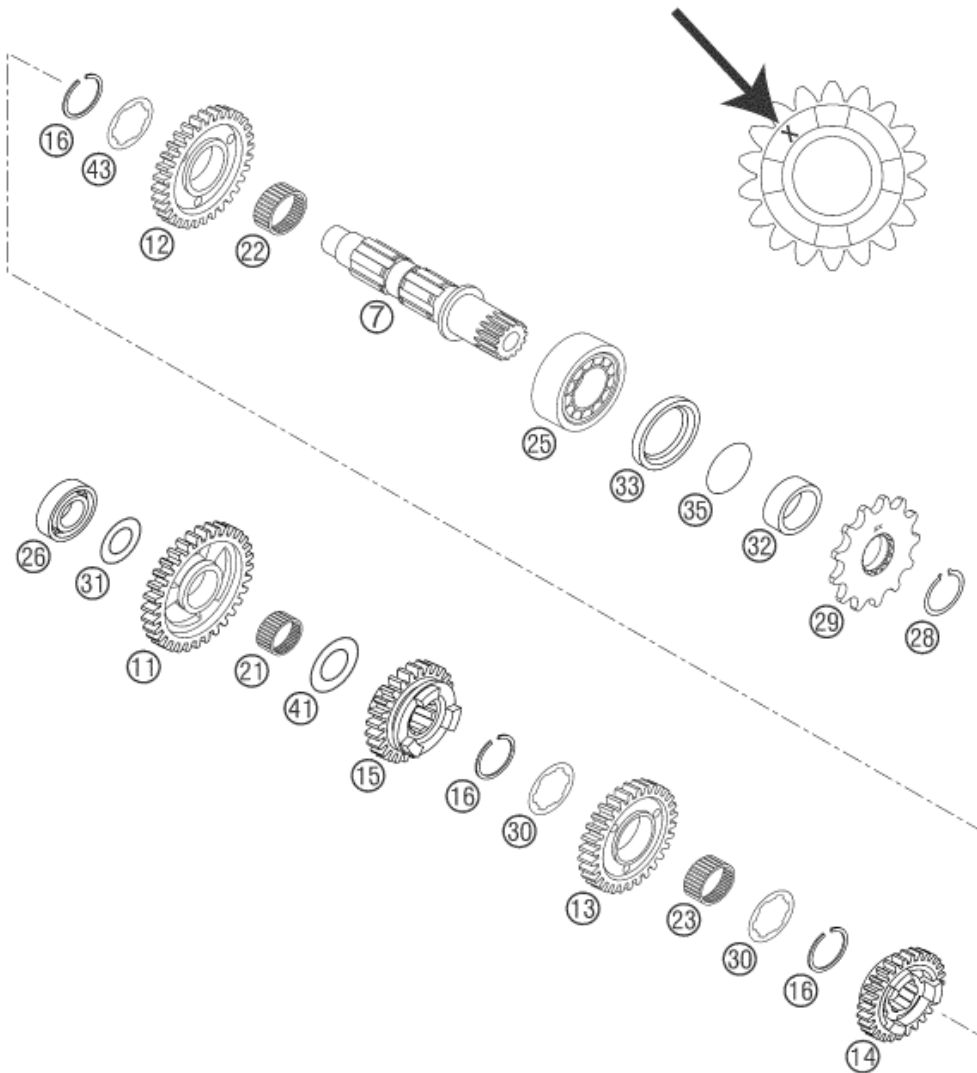

Pos	Part Number	Description	Additional Text	Quantity
7*	54833007000	COUNTERSHAFT 2003		1.00
11*	54833111000	IDLER GEAR 1ST G. 30-T "1E30'		1.00
12*	54833112000	IDLER GEAR 2ND G. 26-T "2E26'		1.00
13*	54833113000	IDLER GEAR 3RD G. 23-T "3E23'		1.00
14*	54833114000	SLIDING GEAR 4TH G.20-T "4E20		1.00
15*	54833115000	SLIDING GEAR 5TH G.23-T "5E23		1.00
16*	54633096000	AXIAL-CIRCLIP 25X1,64		3.00
21*	0405202413	NEEDLE BEAR. K20X24X13		1.00
22*	0405242812	NEEDLE BEAR. K24X28X11,9 DIV.		1.00
23	56533099000	NEEDLE BEAR. K22X26X13 DIVID		1.00
25*	54833025000	BALL BEARING TM-SC05C20C4 NTN		1.00
26*	0625062035	BALL BEARING 6203 JR2 C3		1.00
28	52033096000	LOCK RING DIN0471-25X1,64SD		1.00

29	50033029013	FRONT SPROCKET 13-T		1.00
29	50033029014	FRONT SPROCKET 14-T		0.00
29	50033029015	FRONT SPROCKET 15-T		0.00
30*	59033030000	STOP DISC 25,2X32X1,5		2.00
31*	56033030000	STOP DISC 17,2X30X1		1.00
32*	54833032011	spacer sleeve drive end		1.00
33*	0760324565	SHAFT SEAL RING 32X45X6,5		1.00
35	0770250020	O-RING 25,00X2,00 NBR 70		1.00
41*	59033080000	Shim 20x31.9x1		1.00
43*	50333043000	STOP DISC 25,2X32X1		1.00

\* = New part