

ENTHALTEN IM DICHTSATZ MOTOR LC4
INCLUDED IN GASKET-SET ENGINE LC4

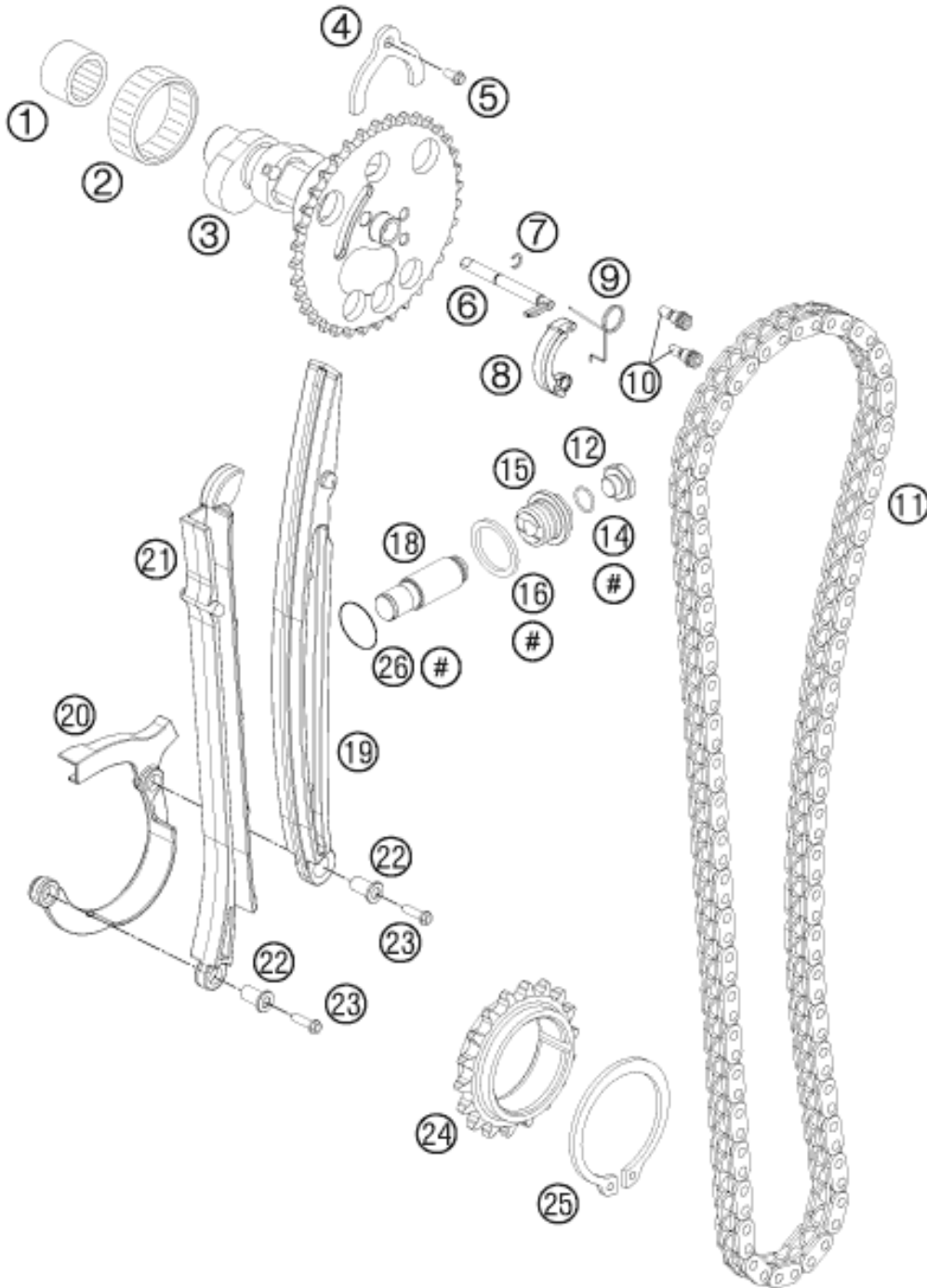

| Pos | Part Number | Description | Additional Text | Quantity |
|-----|-------------|--------------------------------|-----------------|----------|
| 1 | 0618182414 | NEEDLE SLEEVE HK1814RS18/24/14 | | 1.00 |
| 2 | 0618404712 | NEEDLE SLEEVE HK4012B40X47X12 | | 1.00 |
| 3 | 76536010000 | CAMSHAFT | | 1.00 |
| 4 | 75036010050 | CAMSHAFT HOLDER 07 | | 1.00 |
| 5 | 0025060126 | HH collar screw M6x12 TX30 | | 1.00 |
| 6 | 75036016000 | AUTO DECOMPRESSION 07 | | 1.00 |
| 7 | 75036016050 | HALF MOON RING H6-BLS 07 | | 1.00 |
| 8 | 75036015000 | AUTO DECO WEIGHT 07 | | 1.00 |

| | | | | |
|----|-------------|-----------------------------|--|------|
| 9 | 75036017000 | SPRING FOR AUTO DECOMPR. 07 | | 1.00 |
| 10 | 75036019000 | DECO SCREW 07 | | 2.00 |
| 11 | 75036013000 | TIMING CHAIN 104 LINKS 07 | | 1.00 |
| 12 | 77336008010 | HOLDING BOLT | | 1.00 |
| 14 | 0770010010 | o-ring 10.00x1.00 NBR70 | | 1.00 |
| 15 | 75036008000 | SCREW PLUG CHAIN ADJ. 07 | | 1.00 |
| 16 | 0603202702 | CU SEAL-RING 20X27X1 | | 1.00 |
| 18 | 77036003000 | CHAIN ADJUSTER HYD. 05 | | 1.00 |
| 19 | 75036002000 | TENSIONER RAIL 07 | | 1.00 |
| 20 | 75036018000 | SECURING GUIDE 07 | | 1.00 |
| 21 | 75036001000 | GUIDE RAIL 07 | | 1.00 |
| 22 | 75036018050 | SUPPORTING SLEEVE 07 | | 2.00 |
| 23 | 0025060306S | HH collar screw M6x30 TX30 | | 2.00 |
| 24 | 75036014000 | TIMING PULLEY 07 | | 1.00 |
| 25 | 0471300151 | CIRCLIP DIN0471-30X1,5 NIRO | | 1.00 |
| 26 | 0770180020 | o-ring 18.00x2.00 NBR70 | | 1.00 |