

# ENTHALTEN IM DICHTSATZ MOTOR LC4  
INCLUDED IN GASKET-SET ENGINE LC4

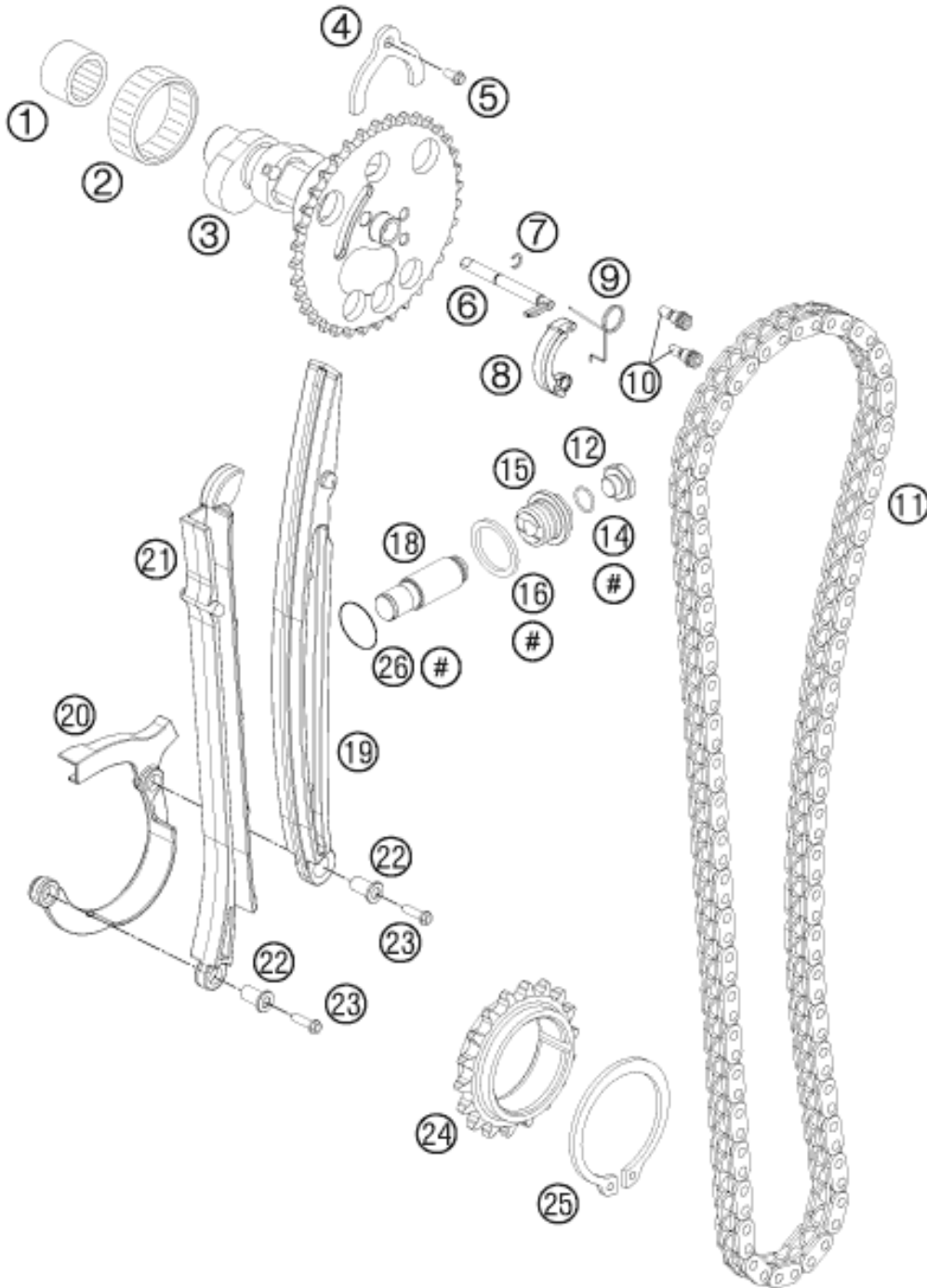

| Pos | Part Number | Description                    | Additional Text | Quantity |
|-----|-------------|--------------------------------|-----------------|----------|
| 1   | 0618182414  | NEEDLE SLEEVE HK1814RS18/24/14 |                 | 1.00     |
| 2   | 0618404712  | NEEDLE SLEEVE HK4012B40X47X12  |                 | 1.00     |
| 3   | 76536010000 | CAMSHAFT                       |                 | 1.00     |
| 4   | 75036010050 | CAMSHAFT HOLDER 07             |                 | 1.00     |
| 5   | 0025060126  | HH collar screw M6x12 TX30     |                 | 1.00     |
| 6   | 75036016000 | AUTO DECOMPRESSION 07          |                 | 1.00     |
| 7   | 75036016050 | HALF MOON RING H6-BLS 07       |                 | 1.00     |
| 8   | 75036015000 | AUTO DECO WEIGHT 07            |                 | 1.00     |

|    |             |                             |  |      |
|----|-------------|-----------------------------|--|------|
| 9  | 75036017000 | SPRING FOR AUTO DECOMPR. 07 |  | 1.00 |
| 10 | 75036019000 | DECO SCREW 07               |  | 2.00 |
| 11 | 75036013000 | TIMING CHAIN 104 LINKS 07   |  | 1.00 |
| 12 | 77336008010 | HOLDING BOLT                |  | 1.00 |
| 14 | 0770010010  | o-ring 10.00x1.00 NBR70     |  | 1.00 |
| 15 | 75036008000 | SCREW PLUG CHAIN ADJ. 07    |  | 1.00 |
| 16 | 0603202702  | CU SEAL-RING 20X27X1        |  | 1.00 |
| 18 | 77036003000 | CHAIN ADJUSTER HYD. 05      |  | 1.00 |
| 19 | 75036002000 | TENSIONER RAIL 07           |  | 1.00 |
| 20 | 75036018000 | SECURING GUIDE 07           |  | 1.00 |
| 21 | 75036001000 | GUIDE RAIL 07               |  | 1.00 |
| 22 | 75036018050 | SUPPORTING SLEEVE 07        |  | 2.00 |
| 23 | 0025060306S | HH collar screw M6x30 TX30  |  | 2.00 |
| 24 | 75036014000 | TIMING PULLEY 07            |  | 1.00 |
| 25 | 0471300151  | CIRCLIP DIN0471-30X1,5 NIRO |  | 1.00 |
| 26 | 0770180020  | o-ring 18.00x2.00 NBR70     |  | 1.00 |