

ACHTUNG !!!
Siehe auch:
"Umbausatz Erzberg Edition".

CAUTION !!!
See also:
"Conversion Kit Erzberg Edition".

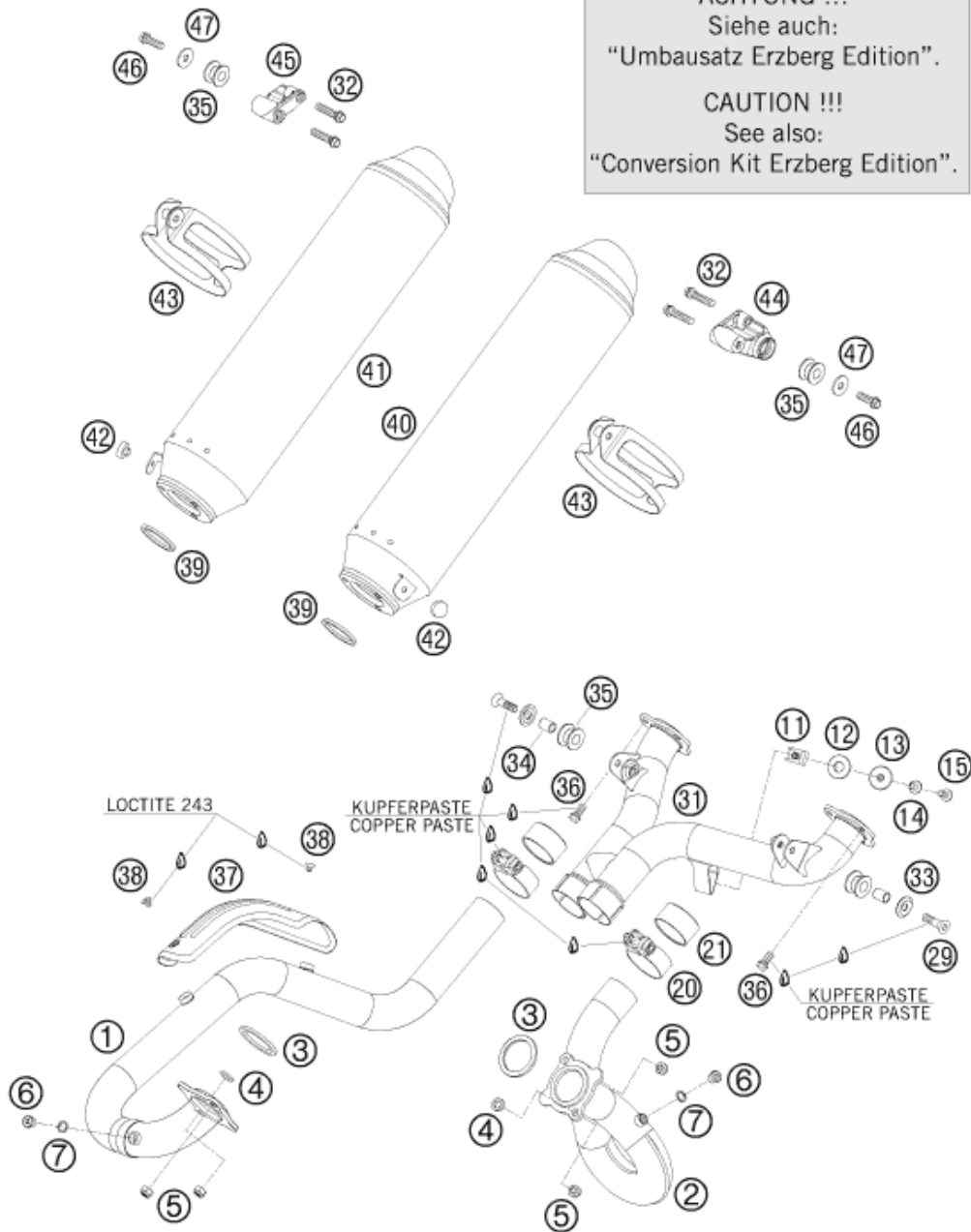

Pos	Part Number	Description	Additional Text	Quantity
1	63005007000	EXHAUST PIPE FRONT 06		1.00
2	60005008000	EXHAUST PIPE REAR 03		1.00
3	60005005000	GASKET 03		2.00
4	0125080003	washer DIN 125 A -8.4		2.00
5	51010086100	self-locking nut M8 Cu		4.00
6	0908100000	PLUG DIN0908-M10X1 A2		2.00
7	0603100141	sealing ring DIN 7603 10x14x1	ONLY FOR LC4 ADVENTURE	2.00
11	54603048100	clip nut M6		1.00
12	51005067000	INSULATE WASHER 8,5X28X3		1.00
13	63005013000	INSULATING DISK 06		1.00
14	54830048000	DISTANCE BUSHING F. CHAIN.		1.00
15	0024060256	HH COLLAR SCREW M6X25 TX30		1.00
20	60105051000	CLAMP CPL. D=49,2MM 06		2.00

21	60005005001	GRAPHIT RING 42X47X25 03		2.00
29	0991080353	FLAT HEAD SCREW DIN7991-M 8X35		2.00
31	63005048000	DISTRIBUTOR TUBE 06		1.00
32	0025080306	HH collar screw M8x30		4.00
33	58303061100	SPECIAL WASHER ALU 8X24 MM ELO		2.00
34	62505069000	SPACER BUSH. 8,5X12X18MM 05		2.00
35	54305068100	damp. component silicone grey		4.00
36	0025080166	HH COLLAR SCREW M8X16 TX40		6.00
37	63005011000	THERMAL SHIELD 06		1.00
38	0991060082	FLAT H.SCREW M6X8 DIN7991 NIRO		2.00
39	60005005002	EXHAUST GASKET 03		2.00
40	62605082000	SILENCER L/S 08		1.00
41	62605083000	SILENCER R/S 08		1.00
42	54308042000	RUBBER BUFFER		2.00
43	60005095000	CLAMP FOR SILENCER CPL. 03		2.00
44	6000508500001S	SILENCER/HANDLE HOLDER L/S 07		1.00
45	6000508600001S	SILENCER/HANDLE HOLDER R/S 07		1.00
46	0025080256	HH collar screw M8x25		2.00
47	0021080003	WASHER DIN9021-A 8,4		2.00