

#9 ENTHALTEN IM DICHTSATZ MOTOR KPL.
INCLUDED IN GASKET-SET ENGINE CPL.

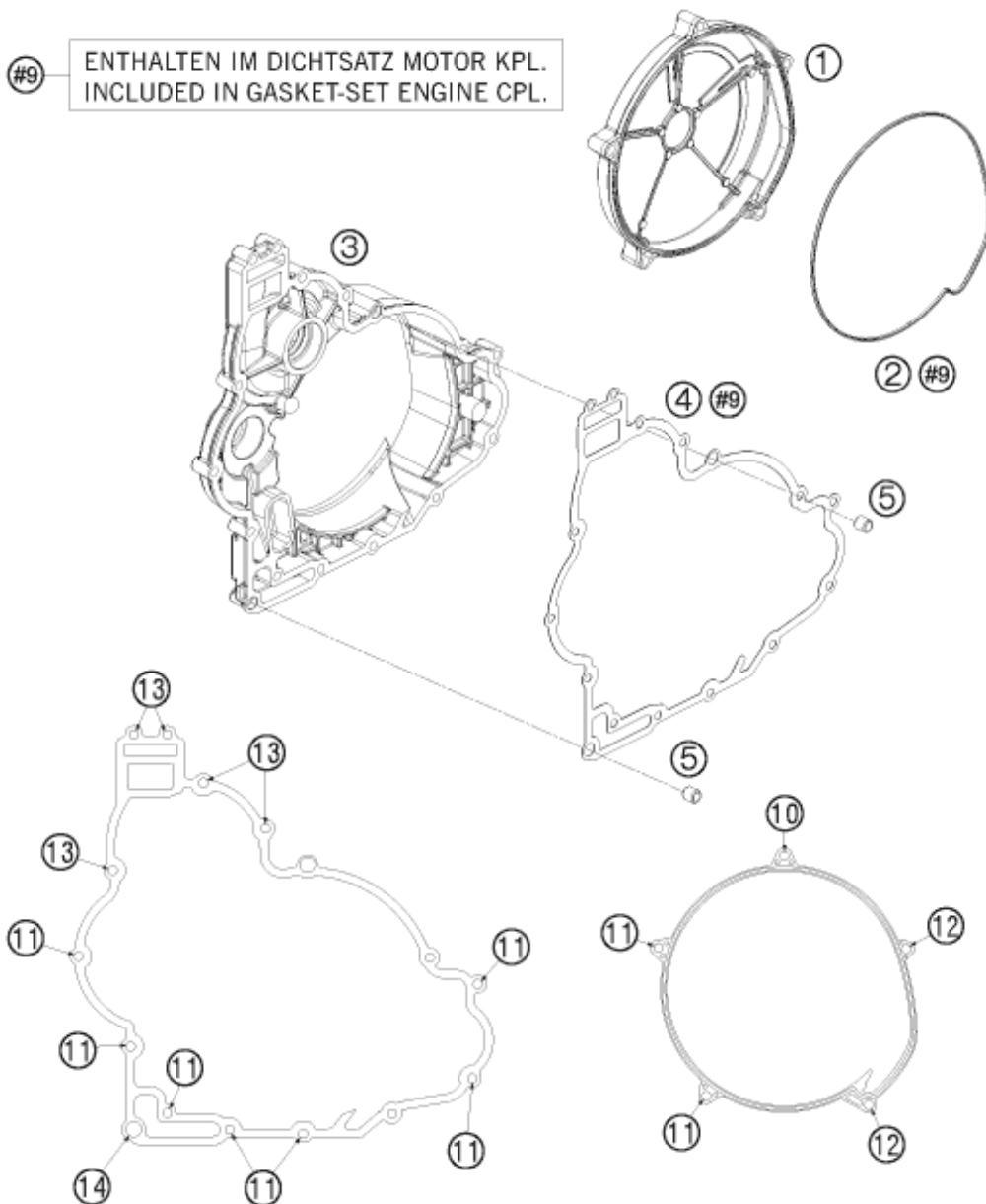

| Pos | Part Number | Description | Additional Text | Quantity |
|-----|---------------|--------------------------------|-----------------|----------|
| 1 | 6123002600041 | OUTER CLUTCH COVER 09 | | 1.00 |
| 2 | 61230027000 | MOLDED RING OUTER CLUTCH COVER | | 1.00 |
| 3 | 6123000104441 | CLUTCH CASE WITH BEARINGS | | 1.00 |
| 4 | 61230025000 | CLUTCH COVER GASKET 08 | | 1.00 |
| 5 | 49030090000 | DOWEL 9,8 X 7 X 10 | FS-E | 2.00 |
| 10 | 0025060956 | HH COLLAR SCREW M6X95 TX30 | | 1.00 |
| 11 | 0025060306 | HH collar screw M6x30 TX30 | | 9.00 |
| 12 | 0025060906 | HH COLLAR SCREW M6X90 TX30 | | 2.00 |
| 13 | 0025060456 | HH COLLAR SCREW M6X45 TX30 | | 5.00 |
| 14 | 0025060356 | HH collar screw M6x35 TX30 | | 1.00 |