



- #1 11 12 13 14 15 19 20
- 24 26 27 30 52 63 64 68

①

12x 0019 050103  
7x 590.30.196.000  
2x 0015 060553  
2x 0912 050123  
1x 773.34.028.000  
1x 773.38.061.000  
1x 773.38.061.050

**+ WELLENDICHTRINGE / SEAL RING**

2x 0760 405560,                    0760 142460  
1x 0760 354771,

**+ LAGER / BEARINGS**

2x 773.30.082.000,    0405 182213,  
2x 546.32.095.000,    0625 062036,  
1x 0625 062054,        0402 255215,  
                                  0625 061806,        0625 068050,  
773.35.050.050.

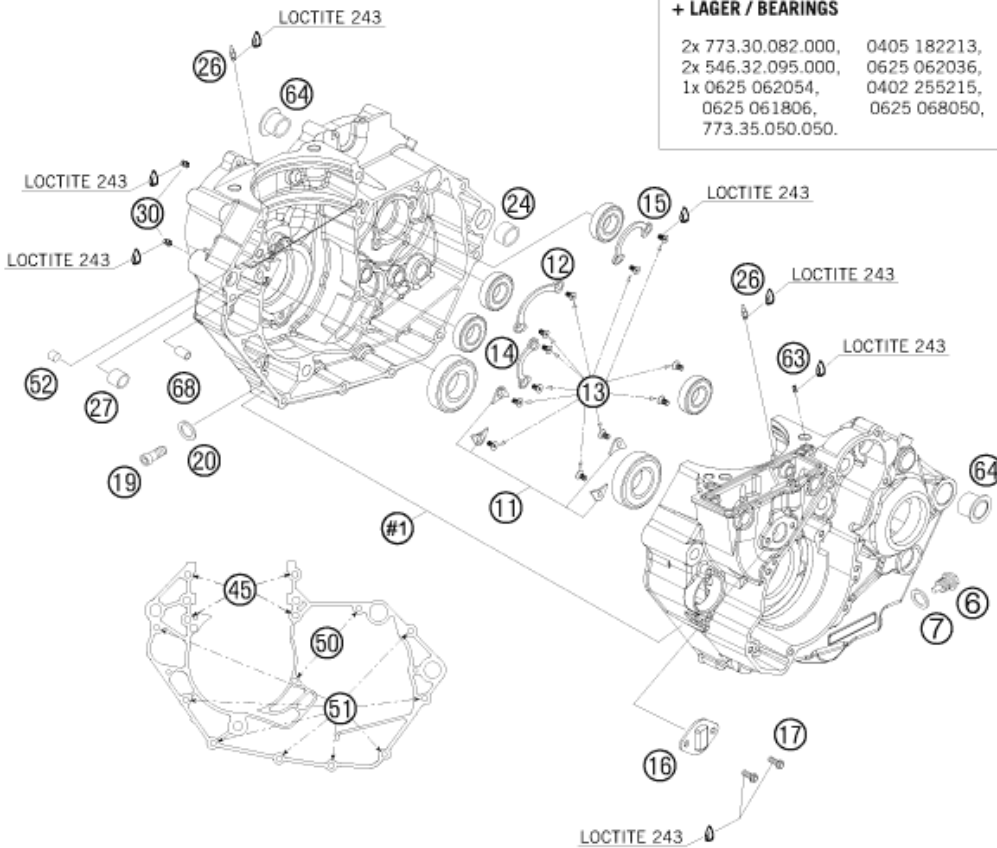

Pos	Part Number	Description	Additional Text	Quantity
1*	77330000244	ENGINE CASE CPL. W.TR.BEAR. 08		1.00
6	58030021000	OILDRAIN PLUG W.MAG. M 12X1,5		1.00
7	58038022000	CU-seal ring DIN7603-12X18X1.5		1.00
11	77330085000	BUSHING RETAINING PLATE		4.00
12	77333022100	BUSHING RETAINING PLATE		1.00
13	0019050103	INT TORX FLAT HEAD M 5X10 8.8		12.00
14	77334090000	BUSHING RETAINING PLATE		1.00
15	77333024100	BUSHING RETAINING PLATE		1.00
16	77336075050	RETAINING PLATE		1.00
17	0015050103	HH COLLAR SCREW M 5X10 WS=8		2.00
19	0012080203	AH SCREW DIN6912-M 8X20		1.00
20	0603082121	SEAL RING CU DIN7603- 8X12X1		1.00
24	59030024000	DOWEL 17 X 19 X 12		1.00
26	60030063050	oil jet 50 M5		2.00
27	54630027000	DOWEL BUSHING 13,8X11X12		1.00
30	59030058000	JET 100 BING(44-031/180) M4		2.00

45*	77330067170	SCREW M7-1,0X70		4.00
50	0015060703	HH COLLAR SCREW M 6X70 WS=8		2.00
51	0015060553	HH COLLAR SCREW M 6X55 WS=8		8.00
52	0402080120	CYLINDER ROLLER ZRO. 8,0X12 M4		2.00
60	77330099000	GASKET SET 450/505 SX-F		1.00
63	77338029052	THROTTLE M5X10X1		1.00
64	75030010000	CASE BUSH		2.00
68	59030023000	dowel sleeve 6x8x11.5		1.00

\* = New part