

Neue Version: Abtriebswelle ① nur in Verbindung mit ⑤ und ②③ ersetzen!

New version: Change countershaft ① only together with parts ⑤ and ②③!

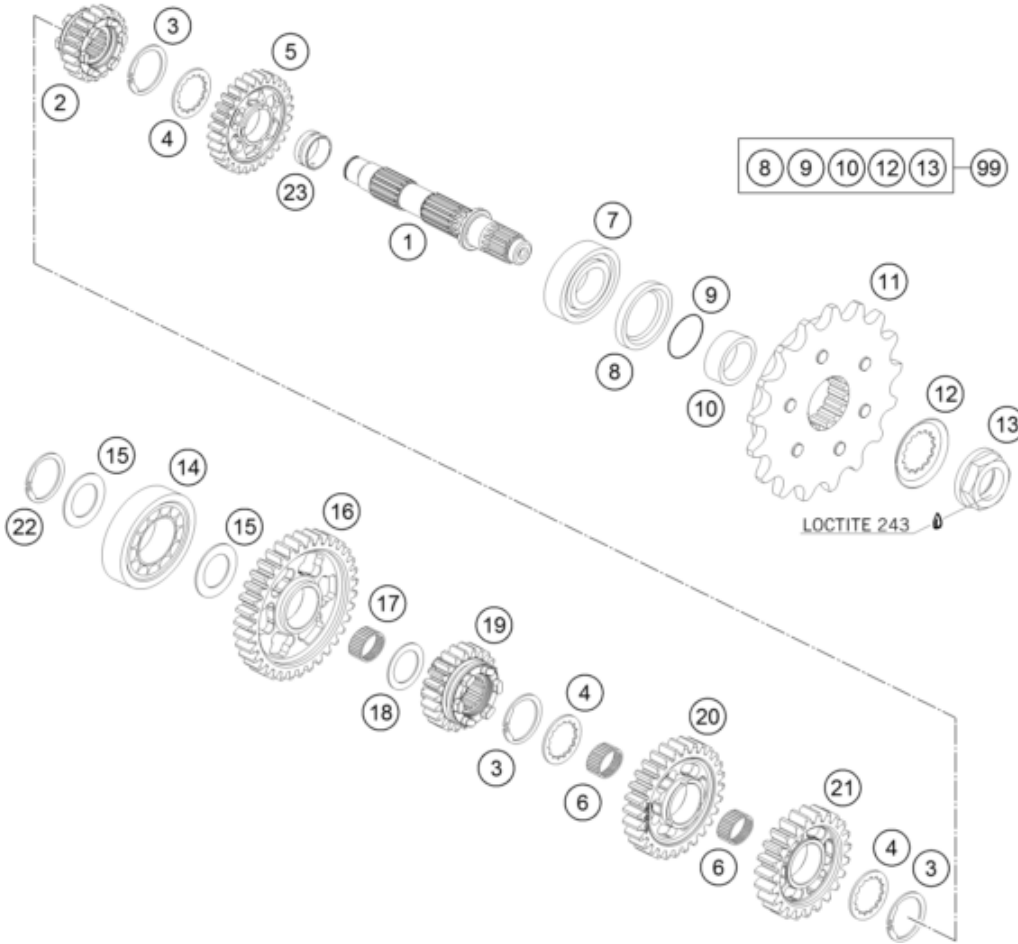

Pos	Part Number	Description	Additional Text	Quantity
1	76233010000	COUNTER SHAFT 07		1.00
2	75033016000	SLIDING GEAR 6TH G. 07		1.00
3	0417025000	CIRCLIP SW25		3.00
4	56533016300	STOP DISK 22,7 X 32 X 1,5		3.00
5	76233012000	IDLER 2. GEAR 07		1.00
6	0405222613	NEEDLE BEAR. K 22X26X13 TN		2.00
7	49030023100	CYL.ROLLER BEARING NJ205 C4		1.00
8	0760324773	radial shaft seal 32x47x7BSL V		1.00
9	0770020220	O-RING 25,12X1,78 NBR70		1.00
10	76633030012	Spacing tube front sprocket		1.00
11	58033029116	Rear sprocket 16-t, damped	SMC	1.00
12	51033031000	locking plate		1.00
13	58033032200	sprocket nut M20x1.5		1.00
14	0625204213	BALL BEARING 6004 C4 N		1.00
15	59033080000	Shim 20x31.9x1		2.00
16	75033011000	IDLER GEAR 1ST GEAR 07		1.00
17	56533098000	NEEDLE BEARING K22X26X13H		1.00
18	54603036000	STOP DISK 22,2X31,7X1		1.00
19	75033015000	5TH GEAR COUNTERSHAFT 07		1.00

20	75033013000	IDLER GEAR 3.G 07		1.00
21	75033014000	IDLER GEAR 4.G 07		1.00
22	0471200120	CIRCLIP DIN471 20X1,2		1.00
23	76233022100	BEARING BUSH		1.00
99	00050000993	Repair kit output shaft 690		0.00