

ACHTUNG !!!
 Bei Bestellung von Getrieberädern, Markierung beachten.
CAUTION !!!
 When ordering transmission gears, check marking.

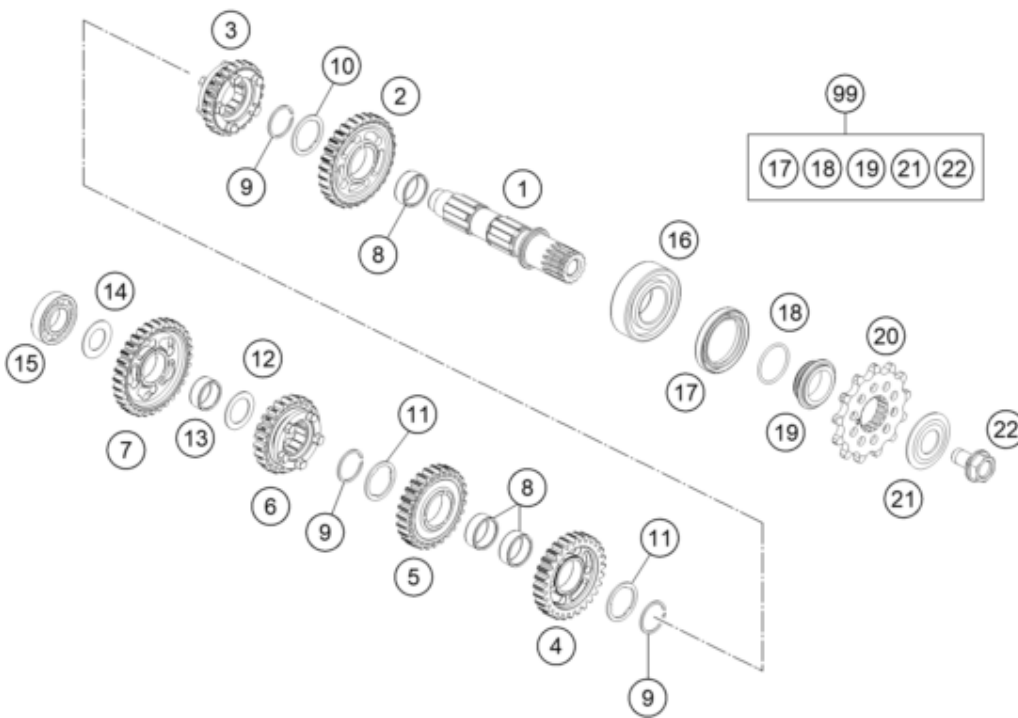

| Pos | Part Number | Description | Additional Text | Quantity |
|-----|-------------|--------------------------------|-----------------|----------|
| 1 | 50533010100 | pinion shaft | | 1.00 |
| 2 | 50533012000 | Idler gear 2nd gear not=30 | | 1.00 |
| 3 | 50533016000 | Sliding gear, 6th gear, teeth= | | 1.00 |
| 4 | 50533013000 | Idler gear, 3rd gear, not=28 | | 1.00 |
| 5 | 50533014000 | Idler 4th gear not=27 | | 1.00 |
| 6 | 50533015000 | Sliding gear, 5th gear, teeth= | | 1.00 |
| 7 | 50533011000 | Idler gear, 1st gear, teeth=32 | | 1.00 |
| 8 | 0405222611 | NEEDLE BEAR.K 22X26X10 DIVIDED | | 3.00 |
| 9 | 0417024000 | CIRCLIP WS24 | | 3.00 |
| 10 | 77733044000 | STOP DISC 24X32X1,5 | | 1.00 |
| 11 | 77733043000 | STOP DISC 23,4X31X1,5 | | 2.00 |
| 12 | 54833080000 | STOP DISC 20,2X30X1 | | 1.00 |
| 13 | 0405202410 | NEEDLE BEARING K20X24X10 | | 1.00 |
| 14 | 56033030000 | STOP DISC 17,2X30X1 | | 1.00 |
| 15 | 0625160031 | GROOVED BALL B. 16003 C4 J1 | | 1.00 |
| 16 | 0625062054 | BALL BEARING 6205 C3 NTN | | 1.00 |
| 17 | 0760324571 | SHAFT SEAL RING 32X45X7 BSLNBR | | 1.00 |

| | | | | |
|----|--------------|-----------------------------|--|------|
| 18 | 0770020220 | O-RING 25,12X1,78 NBR70 | | 1.00 |
| 19 | 78133014000 | SPACER SLEEVE COUNTER | | 1.00 |
| 20 | A46033029013 | Front sprocket 13 teeth | | 1.00 |
| 21 | 59033034000 | Spring washer 17.2X40X1.5 | | 1.00 |
| 22 | 59033029000 | HH COLLAR SCREW M10X18 10.9 | | 1.00 |
| 99 | 00050000991 | Repair kit countershaft 125 | | 1.00 |