

- #1
3
4
11
12
14
19
27
28

+ WELLENDICHTRINGE / SEAL RING

1x 0760142460 1x 47030076100
 1x 0760253570 1x 0760324571
 1x 0760385273

+ LAGER / BEARINGS

1x 56530123200 1x 79234012010
 1x 0625160040 1x 0625006065
 1x 49030023000 1x 0410002500700
 1x 55430058000 1x 0625062054
 1x 0625623204 1x 0625063022
 1x 0625062038 2x 54632095000

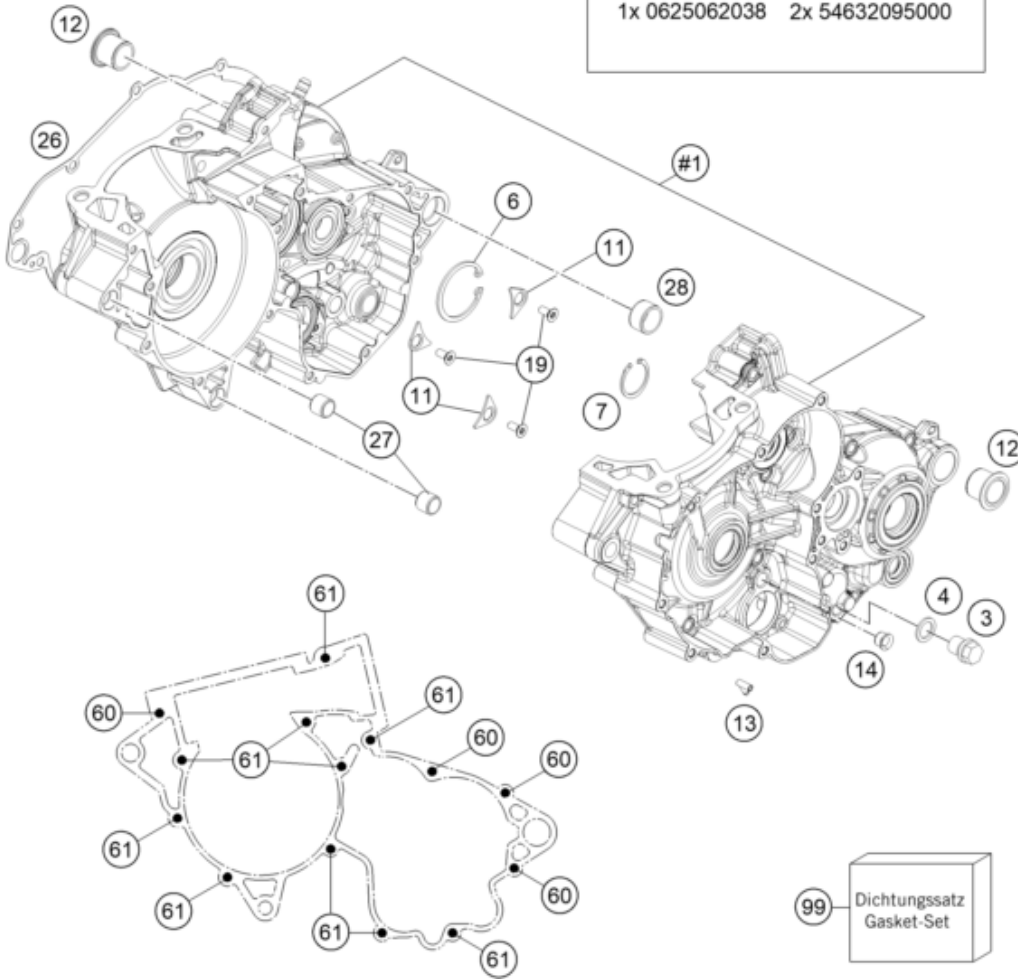

Pos	Part Number	Description	Additional Text	Quantity
1	A44030000044	Engine case cmpl.		1.00
3	58030021100	oil drain plug with magnet		1.00
4	58038022000	CU-seal ring DIN7603-12X18X1.5		1.00
6	0472042175	CIRCLIP DIN0472-42X1,75		1.00
7	55430059100	CIRCLIP DIN0472-28X1,2		1.00
11	75030085100	Retaining bracket crankshaft b		3.00
12	79230010000	Housing bush		2.00
13	45130022000	ANGLE PIECE 50CCM LC 2001		1.00
14	55540031000	Collar bushing		1.00
19	0019050121S	INT. TORX FLAT HEAD M5X12 T25		3.00
26	A44030025000	Clutch cover gasket, inner		1.00
27	54630027000	DOWEL BUSHING 13,8X11X12		2.00
28	54830027100	Dowel, 21x12		1.00

60	0025060606	HH collar screw M6x60 TX30		4.00
61	0025060456	HH COLLAR SCREW M6X45 TX30		10.00
99	A44030099000	Gasket kit Engine MX 250/300		0.00