

- 1
- 4 5 6 7 8 12 13 14
15 18 19
- 2x 79430084000
1x 77038013100
1x 77233088000
- + WELLENDICHTRINGE / SEAL RING**
1x 0760324571
1x 0760142461
- + LAGER / BEARINGS**
2x 79430082000 1x 49030023000
1x 79430057010 2x 54632095000
1x 0625062056 1x 79438001010
1x 0625160041 1x 0410002500700
1x 0625062038 1x 79234012010

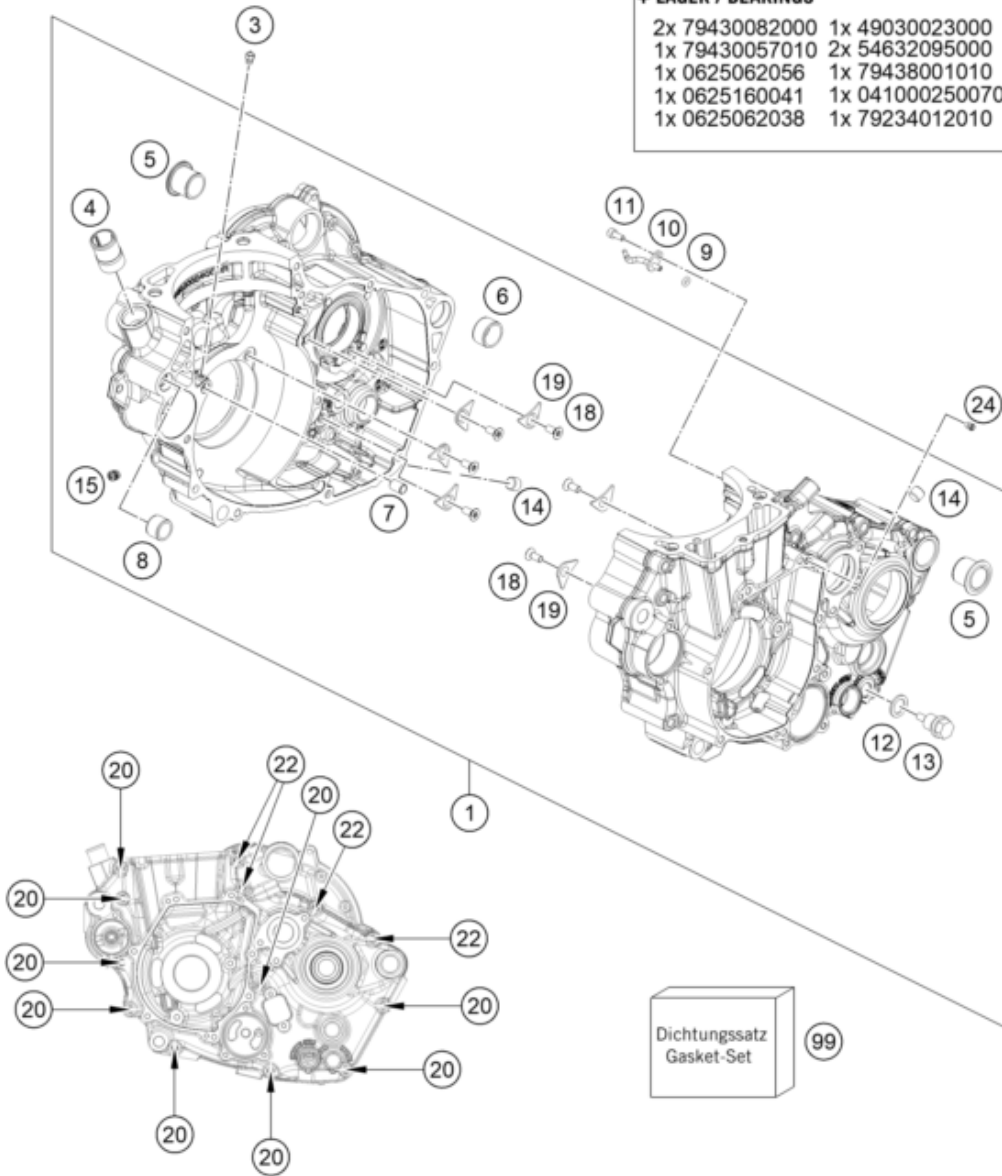

Pos	Part Number	Description	Additional Text	Quantity
1	A48030000044	engine case cpl.		1.00
3	60030063070	oil jet 70 M5		1.00
4	58030010200	SCREW IN NOZZLE M20X1,5		1.00
5	79230010000	Housing bush		2.00
6	54830027100	Dowel, 21x12		1.00
7	59030023100	Dowel, 6x8x11.5		1.00
8	54630027000	DOWEL BUSHING 13,8X11X12		1.00
9	0770035020	O-RING 3,5X2,00 NBR		1.00
10	81230064000	OIL JET ANGLED 70		1.00

11	0912040103S	Cylinder screw DIN 912-M4x10-8		1.00
12	58038022000	CU-seal ring DIN7603-12X18X1.5		1.00
13	58030021100	oil drain plug with magnet		1.00
14	0906100100	pipe plug DIN 906 M10x1		2.00
15	59030296000	SCREW PLUG		3.00
18	0019050121S	INT. TORX FLAT HEAD M5X12 T25		6.00
19	75030085100	Retaining bracket crankshaft b		6.00
20	0025060656	HH COLLAR SCREW M6X65 TX30		9.00
22	0025060806	HH COLLAR SCREW M6X80 TX30		4.00
24	59030058000	JET 100 BING(44-031/180) M4		1.00
99	A48030099000	engine gasket kit MX 450		0.00