

DICHTUNGSSATZ KPL. 600.30.099.000
ENTHÄLT DICHT.SATZ ZYL.KOPF 600.30.097.000
GASKET-SET CPL. 600.30.099.000
INCL. GASKET-SET CYL. HEAD 600.30.097.000

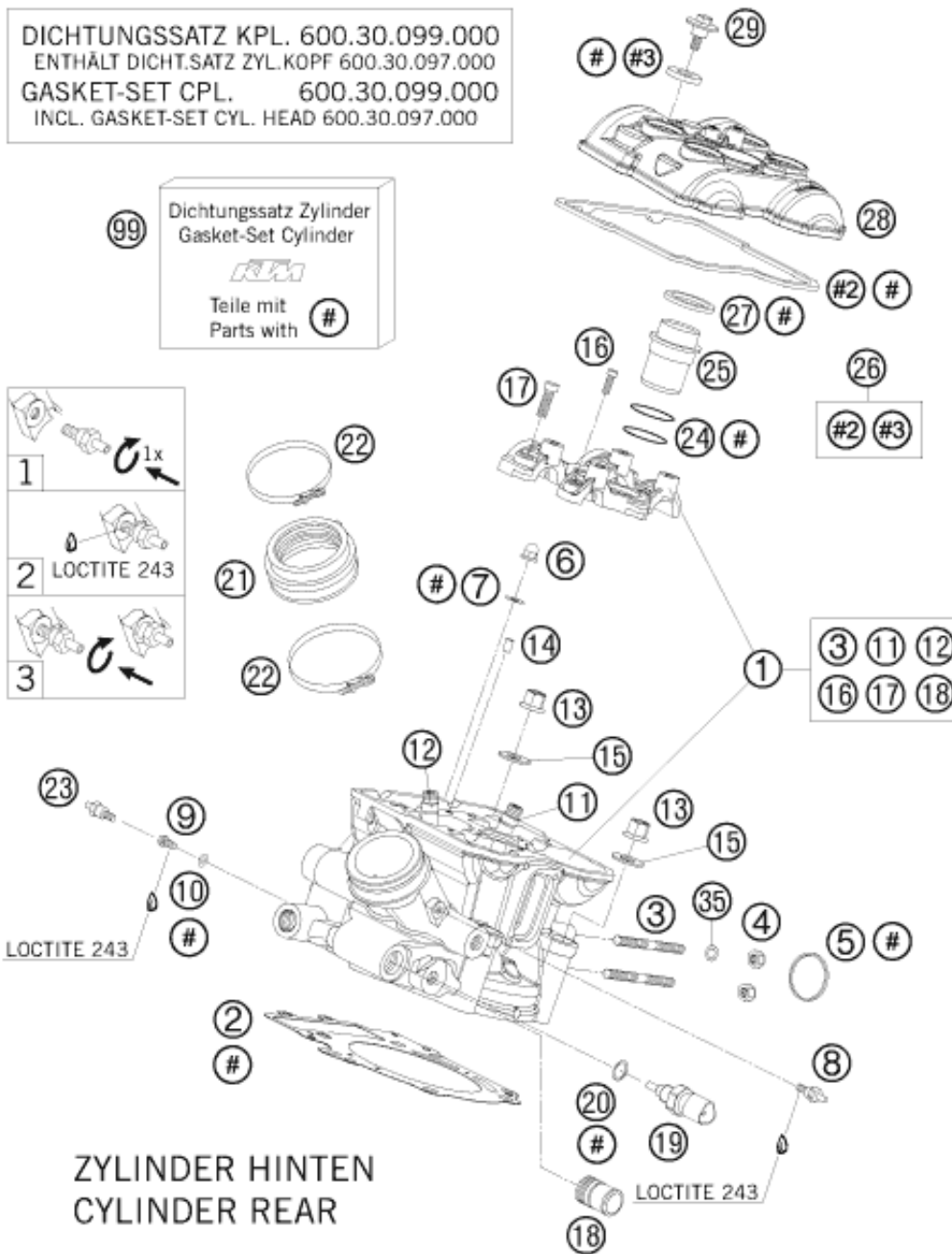

LOCTITE 243

ZYLINDER HINTEN
CYLINDER REAR



Pos	Part Number	Description	Additional Text	Quantity
1	6113612014423	CYLIDNER HEAD CPL. REAR 08		1.00
2	60030036000	CYLINDER HEAD GASKET 0,5 101MM		1.00
3	0835080256	STUD DIN0835-M 8X25 10.9		2.00
4	51010086100	self-locking nut M8 Cu		2.00
5	61005005000	Exhaust gasket 05		1.00
6	61230045000	CAP NUT M6 STAINLESS STEEL		2.00
7	0125060003	WASHER DIN0125-A 6,4		2.00
8	61036023100	VACUUM CONECTION 2006		1.00
9	0025060083	COLLAR SCREW M6X8 TX		1.00
10	0603061001	CU-SEAL RING DIN7603-6X10X1		1.00
11	61136026001	VALVE GUIDE OUTLET		2.00
12	61136025001	VALVE GUIDE OUTTAKE		2.00
13	60036078200	hex collar nut M10 WS13		4.00

14	0402050980	needle roller DIN 5402 5x9.8		2.00
15	60036078050	SHIM 10,2X19X1,5MM 05		4.00
16	0912060255	AH SCREW DIN0912-M 6X25 10.9		4.00
17	0984080305	AH SCREW DIN7984-M 8X30 10.9		4.00
18	61135019000	WATER CONNECTION		1.00
19	75035047000	TEMPERATURE SENSOR WATER 07		1.00
20	0770100020	o-ring 10.00x2.00 silicone	ONLY FOR LC4 ADVENTURE	1.00
21	61136044000	RUBBERSLEEVE INTAKE FLANGE		1.00
22	61236048000	hose clamp Gemi 66		2.00
23	60036023100	VACUUM CONNECTION M6/0,5MM	WITH 2 MARKING GROOVES	1.00
24	0770298178	O-RING 29,87X1,78 VITON		2.00
25	61136075100	INSERT SPARK-PLUG SHAFT		1.00
26	61136099000	VALVE COVER GASKETSETFR+RR		1.00
27	61136075050	spark plug shaft gasket		2.00
28	6113615200023	VALVE COVER REAR 09		1.00
29	60036052020	collar screw M 6 WS=10 03		4.00
35	61005009000	SPACER BUSH. 8,5X15X7,5 05		1.00
99	60030097000	GASKET SET CYL. HEAD KPL. 03	CYLINDER FRONT + REAR	1.00