

ACHTUNG !!!
 Mit dem Wellendichtring auch
 die Wasserpumpenwelle wechseln.

CAUTION !!!
 With the shaft seal ring also
 change the water-pump shaft.

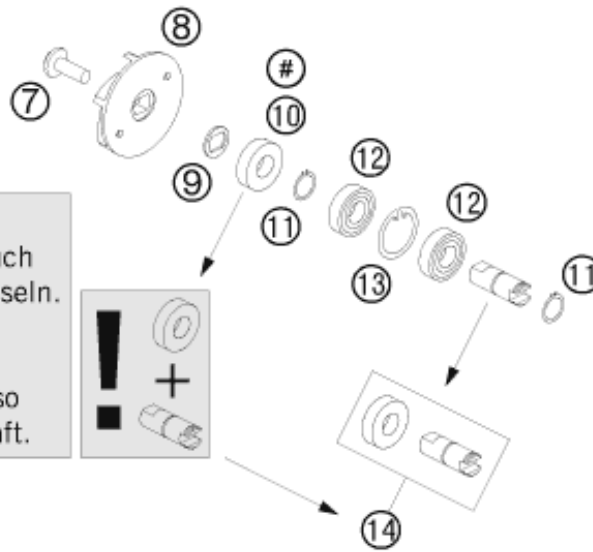

| Pos | Part Number | Description | Additional Text | Quantity |
|-----|-------------|-------------------------------|-----------------------|----------|
| 1 | 0015060103 | HH COLLAR SCREW M 6X10 WS=8 | FC | 2.00 |
| 2 | 0603061001 | CU-SEAL RING DIN7603-6X10X1 | | 2.00 |
| 3 | 0015060163 | HH COLLAR SCREW M 6X16 WS=8 | FE, FS | 2.00 |
| 4 | 60035052000 | WATER-PUMP COVER 03 | | 1.00 |
| 5 | 60035053000 | WATER-PUMP GASKET 03 | | 1.00 |
| 6 | 59030023000 | dowel sleeve 6x8x11.5 | | 2.00 |
| 7 | 0014060153 | HH COLLAR SCREW M 6X15 WS=8 | | 1.00 |
| 8 | 60035055100 | WATER-PUMP WHEEL LC8 03 | | 1.00 |
| 9 | 60035055150 | double-d washer 16x1 SST | | 1.00 |
| 10* | 0760123073 | SHAFT SEAL RING 12X30X7 PTFE | DOUBLE-LIP | 1.00 |
| 11 | 0471120010 | retaining ring DIN 471 12x1 | | 2.00 |
| 12 | 0625069010 | GROOVED BALL BEARING 6901V C3 | | 2.00 |
| 13 | 0472240120 | CIRCLIP DIN472 D=24X1,2 | | 1.00 |
| 14* | 60035054144 | WATER PUMP SHAFT W/ SEAL RING | INCL. SHAFT SEAL RING | 1.00 |

| | | | | |
|----|-------------|--------------------------------|--|------|
| 15 | 0770250030 | O-RING 25,00X3,00 NBR 70 | | 2.00 |
| 16 | 60035021000 | ALUMINUM TUBE WATER-PUMP+CLAMP | | 1.00 |
| 17 | 60035021050 | FIXING CLAMP WATER-P. TUBE 03 | | 1.00 |
| 18 | 0015060603 | HH COLLAR SCREW M 6X60 WS=8 | | 4.00 |
| 99 | 60035055010 | WATER PUMP REP. KIT 09-13 | | 0.00 |

* = New part