

**ACHTUNG!**

Ersatzteile nur für Motoren mit Seriennummer  
L79139921 bis L79141829

**ATTENTION!**

Spare parts only for engines with serial number  
L79139921 to L79141829

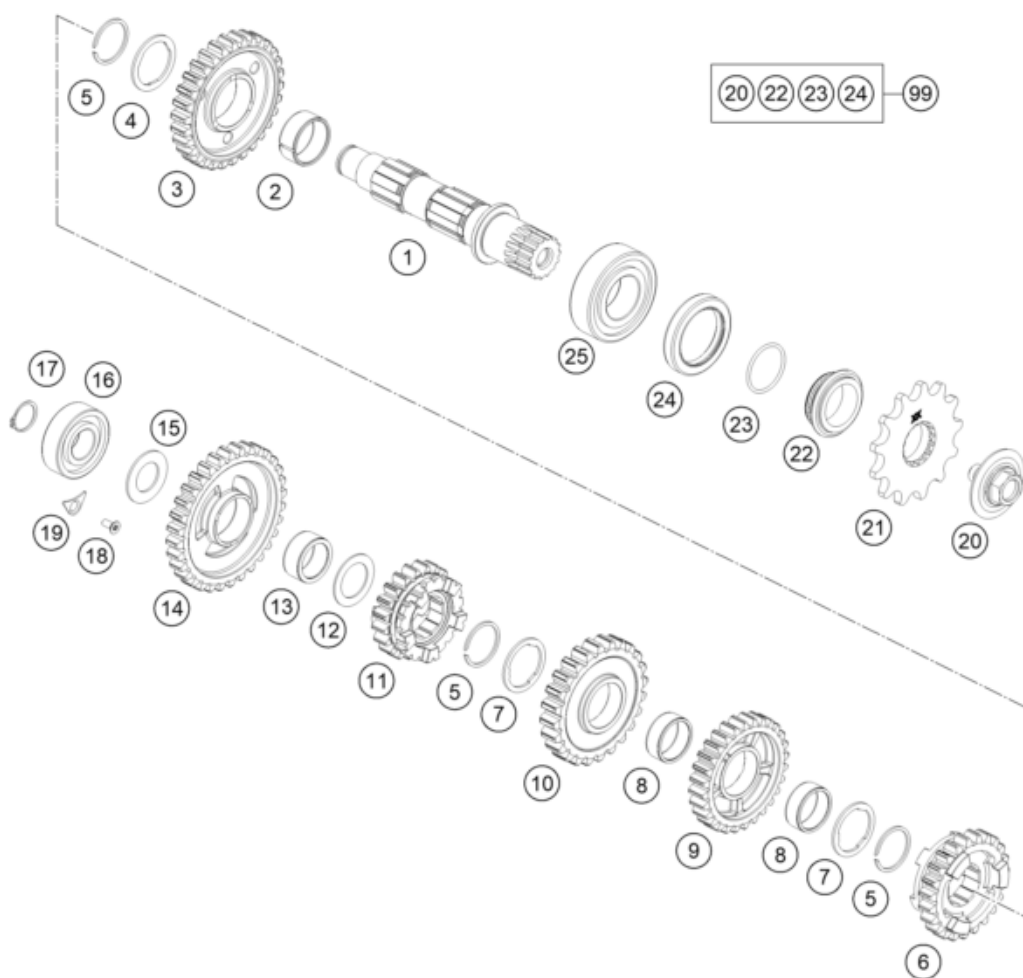

Pos	Part Number	Description	Additional Text	Quantity
1	79133110000	Countershaft		1.00
2	0405242812	NEDDLE BEAR. K24X28X11,9 DIV.		1.00
3	79133112000	Idler gear, 2nd gear, teeth=30		1.00
4	77733044000	STOP DISC 24X32X1,5		1.00
5	0417024000	CIRCLIP WS24		3.00
6	79133115000	Sliding gear, 5th gear, teeth=		1.00
7	77733043000	STOP DISC 23,4X31X1,5		2.00
8	0405222611	NEEDLE BEAR.K 22X26X10 DIVIDED		2.00
9	79133114000	Idler gear, 4th gear, teeth=28		1.00
10	79133113000	Idler gear, 3rd gear, teeth=24		1.00
11	79133116000	Sliding gear, 6th gear, teeth=		1.00
12	54833080000	STOP DISC 20,2X30X1		1.00

13	0405202612	NEEDLE BEARING K 20X26X12		1.00
14	79133111000	Idler gear, 1st gear, teeth=32		1.00
15	77233020000	STOP DISK 17,2X30X1,3		1.00
16	0625062035	BALL BEARING 6203 JR2 C3		1.00
17	0471170015	CIRCLIP DIN 0471-17X1, 5		1.00
18	0019050121S	INT. TORX FLAT HEAD M5X12 T25		1.00
19	75030085000	RETAINING PLATE F. CS BEARING		1.00
20	59033034044	SCREW 10.9+SPRING WASHER		1.00
21	79233029013	Sprocket 13-t		0.00
21	79233129014	ENGINE SPROCKET 14Z		0.00
22	78133014000	SPACER SLEEVE COUNTER		1.00
23	0770020220	O-RING 25,12X1,78 NBR70		1.00
24	0760324571	SHAFT SEAL RING 32X45X7 BSLNBR		1.00
25	49030023000	cylindrical roller bearing NJ2		1.00
99	00050000941	COUNTER SHAFT REP.KIT 4 STROKE		0.00