

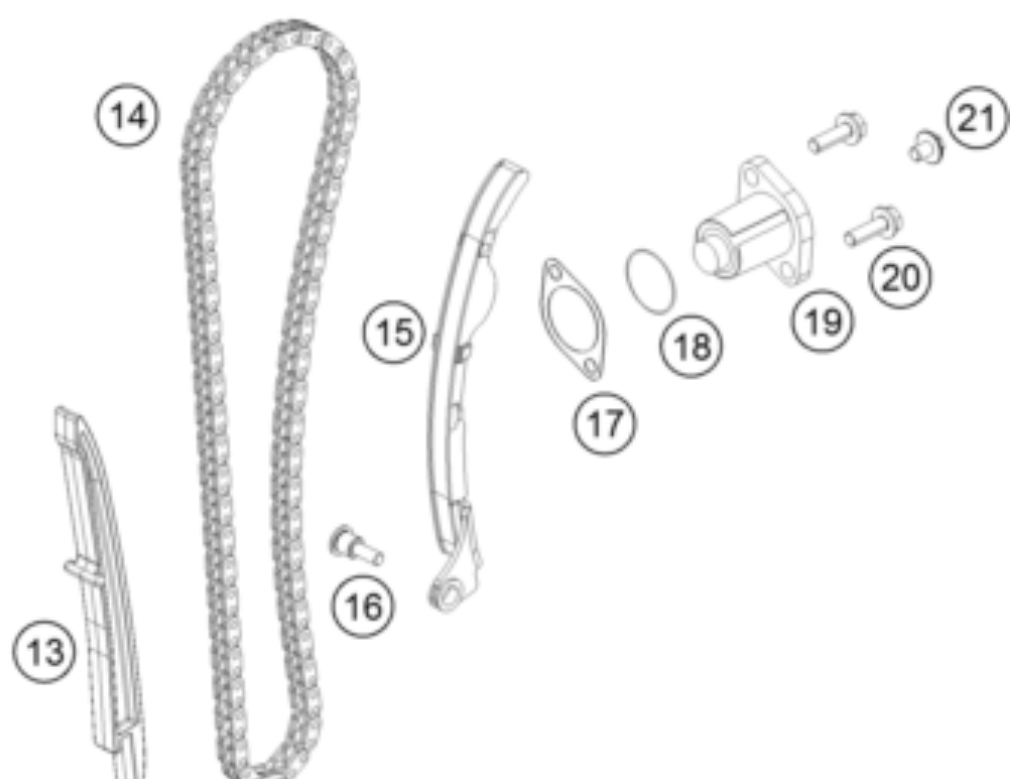

250 Duke, white, w/o ABS-B.D. 2019 <2019><EU><F4203S4L>
TIMING DRIVE
51995

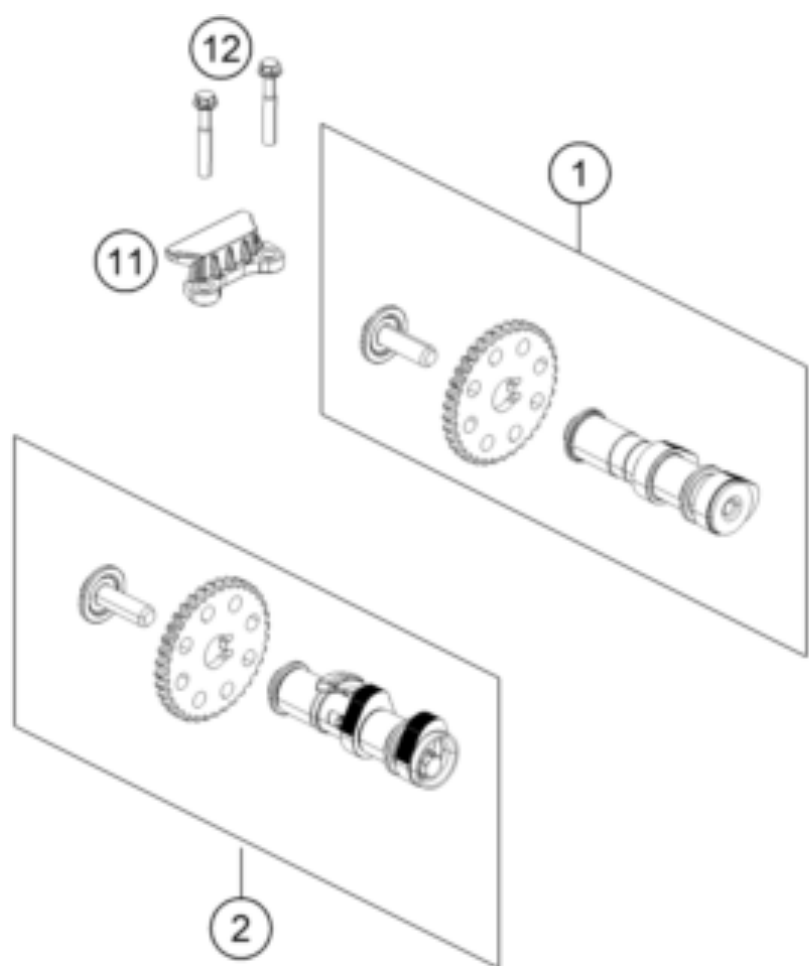

| Pos | Part Number | Description | Additional Text | Quantity |
|-----|-------------|--------------------------------|-----------------|----------|
| 1 | 93736009133 | Camshaft inlet valve, complete | | 1.00 |
| 2 | 93736010133 | Camshaft exhaust valve, comple | | 1.00 |
| 11 | 90236018000 | CHAIN GUIDE TOP | | 1.00 |
| 12 | J025060401 | HH COLLAR SCREW M6X40 | | 2.00 |
| 13 | 90236001000 | TIMING CHAIN GUIDE | | 1.00 |
| 14 | 90236013000 | TIMING CHAIN | | 1.00 |
| 15 | 90236002000 | TENSIONER RAIL CPL. | | 1.00 |
| 16 | 90236002004 | SCREW TENSIONER RAIL | | 1.00 |
| 17 | 90136003003 | GASKET CHAIN ADJUSTER | | 1.00 |
| 18 | J770010015 | O-RING 10,15X1,5 | | 1.00 |
| 19 | 90236003044 | CHAIN ADJUSTER | | 1.00 |
| 20 | J025060201 | HH COLLAR SCREW M6X20 | | 2.00 |
| 21 | 90136003002 | SPECIAL SCREW 6X6 | | 1.00 |