

**ACHTUNG!!!**  
Pos. 18 und 19 müssen  
gemeinsam getauscht werden!

**CAUTION!!!**  
Pos. 18 and 19 have to be  
changed together!

# ENTHALTEN IM DICHTSATZ MOTOR  
INCLUDED IN GASKET SET ENGINE

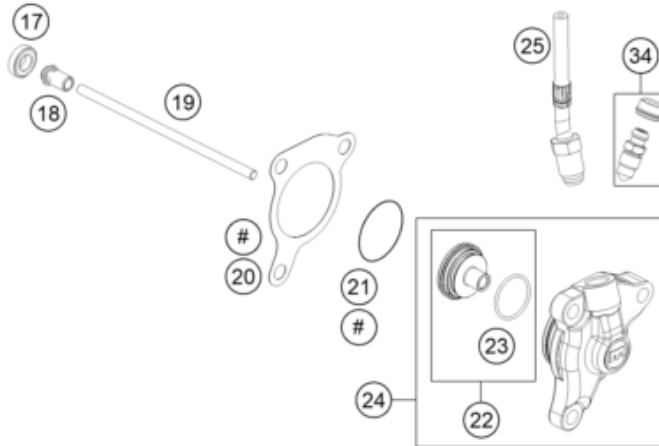
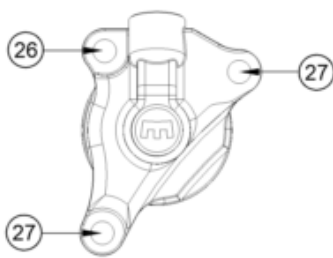

| Pos | Part Number  | Description              | Additional Text | Quantity |
|-----|--------------|--------------------------|-----------------|----------|
| 1*  | 014580050306 | Cyl.screw DIN14580 M5x30 |                 | 4.00     |
| 2*  | 76632006000  | Anticentrifugal ring     |                 | 1.00     |
| 3   | 58532080000  | CLUTCHSPRING 3,0X33,5    |                 | 4.00     |
| 4*  | 76632003044  | pressure plate           |                 | 1.00     |
| 5   | 60036073150  | hex nut M20x1, H=6mm     |                 | 1.00     |
| 6   | 75032018100  | Lock washer              |                 | 1.00     |
| 7*  | 76632002002  | Movable Hub              |                 | 1.00     |
| 8   | 75032033000  | CLUTCH RELEASE SPRING    |                 | 4.00     |
| 9*  | 76632002001  | Fixed Hub                |                 | 1.00     |
| 10  | 75032009000  | STEPPED WASHER 07        |                 | 1.00     |
| 11  | 75032007000  | HALF-WASHER 07           |                 | 2.00     |

|     |             |                                |  |      |
|-----|-------------|--------------------------------|--|------|
| 12* | 75032001144 | CLUTCH CAGE CPL. 79T           |  | 1.00 |
| 14  | 75032050001 | OIL PUMP DRIVE WHEEL 07        |  | 1.00 |
| 15  | 56532095000 | NEEDLE BEARING K26X30X22ZW.KSE |  | 1.00 |
| 16  | 75032017000 | WASHER 26X40X2 07              |  | 1.00 |
| 17  | 0625060016  | deep groove ball bearing 6001. |  | 1.00 |
| 18  | 75032055100 | PRESSURE BOLT 08               |  | 1.00 |
| 19  | 75032054200 | PUSH ROD 08                    |  | 1.00 |
| 20  | 59032065100 | GASKET F. OUTPUT CYLINDER      |  | 1.00 |
| 21  | 0770300015  | O-ring 30x1.5 NBR 70           |  | 1.00 |
| 22  | 26632066000 | PISTONKIT OUTPUT ZYL. DOT 27MM |  | 1.00 |
| 23  | 26632067000 | O-Ring 23,52x1,78 EPDM         |  | 1.00 |
| 24  | 79432061144 | Output Cyl. Dot Cpl. 27mm      |  | 1.00 |
| 25* | 76032063000 | CLUTCH PIPE 1100MM             |  | 1.00 |
| 26  | 0025060206  | HH collar screw M6x20 TX30     |  | 1.00 |
| 27  | 0025060356  | HH collar screw M6x35 TX30     |  | 2.00 |
| 28  | 75032112000 | STEEL DISK 1,5 MM LC4 '07      |  | 6.00 |
| 29  | 58332011300 | LINING DISK 2,7MM FCC 02       |  | 7.00 |
| 30  | 58632016000 | RONDELLA ANTIVIBRAZIONE SET    |  | 1.00 |
| 31  | 75032111100 | LINING DISC CUT OUT            |  | 1.00 |
| 32  | 75032112100 | STEEL DISK 1,5MM NITRIDED      |  | 1.00 |
| 33  | 75032032000 | HOLDING SCREW GMB-M5X35        |  | 2.00 |
| 34  | 54732064000 | BLEEDER SCREW WITH CAP         |  | 1.00 |
| 99  | 75032011110 | CLUTCH KIT 690/701             |  | 1.00 |

\* = New part