

**CHOKE BETÄTIGUNG
SIEHE VERGASER!**
**CHOKE SYSTEM
SEE CARBURETOR!**

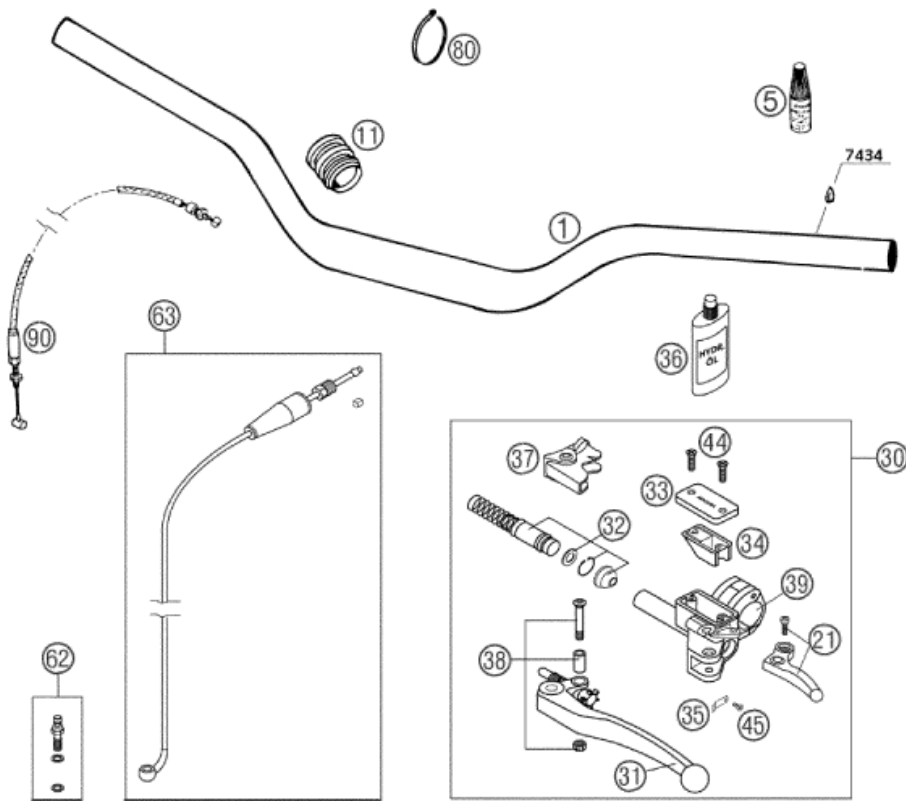

Pos	Part Number	Description	Additional Text	Quantity
1	58302001300	ALU-HANDLEBAR SX,SC,ADVENT.'97		1.00
5	6899792	GRIP GLUE		1.00
10*	58502010000	THROTTLE GRIP 02		1.00
11	54605057000	RUBBER SLEEVE D=21MM/23MM '93	125/200 SX, 125 EXC	1.00
21	59002047000	LEVER CPL. RACING 2000		1.00
30	59002030000	MASTERCYLINDER CPL.RACING '00		1.00
31	50302031000	CLUTCH LEVER CPL. 125-200 '98		1.00
31	50302031100	CLU.LEVER SHORT CPL. 2T 2000		1.00
32	59002032000	REP.KIT PISTON 9,5MM RAC. 2000		1.00
33	59002033000	COVER HYD.CLUTCH RACING 2000		1.00
34	50302034000	RUBBER FOR RESERVOIR '98		1.00

35	50302035000	SPRING PLATE FOR LEVER '98		1.00
36	50302036000	OIL FOR HYD.CLUTCH 50ML		1.00
37	50302037000	PROTECT.CAP FOR LEVER PERCH'98		1.00
38	50302038000	LEVER SCREW CPL. 125-200 '98		1.00
39	50302030150	CLAMP WITH PIN 2000	ZINKCOATED	1.00
44	0965040123	FLAT HEAD SCREW DIN0965-M 4X12		2.00
45	0984030063	AH SCREW DIN7984-M 3X 6		1.00
54	58502039044	RUBBER GRIPS PER GRIP 96-05		1.00
62	58532062000	HOLLOW SCREW F.HYDR.CLUTCH 01		1.00
63	58532063000	PIPE KIT FOR HYDR.CLUTCH		1.00
80	44011076200	CABLE TIE 200/3,6MM BLACK		0.00
90	58302094000	DECOMPRESSION CABLE LC4 '93		1.00
91	59002091200	THR.CABLE"OPEN-CLOSE" RAC.20	CONSTRUCTION FOR KNEE PIECE	1.00

* = New part