

#9 ENTHALTEN IM DICHTSATZ MOTOR KPL.
INCLUDED IN GASKET-SET ENGINE CPL.

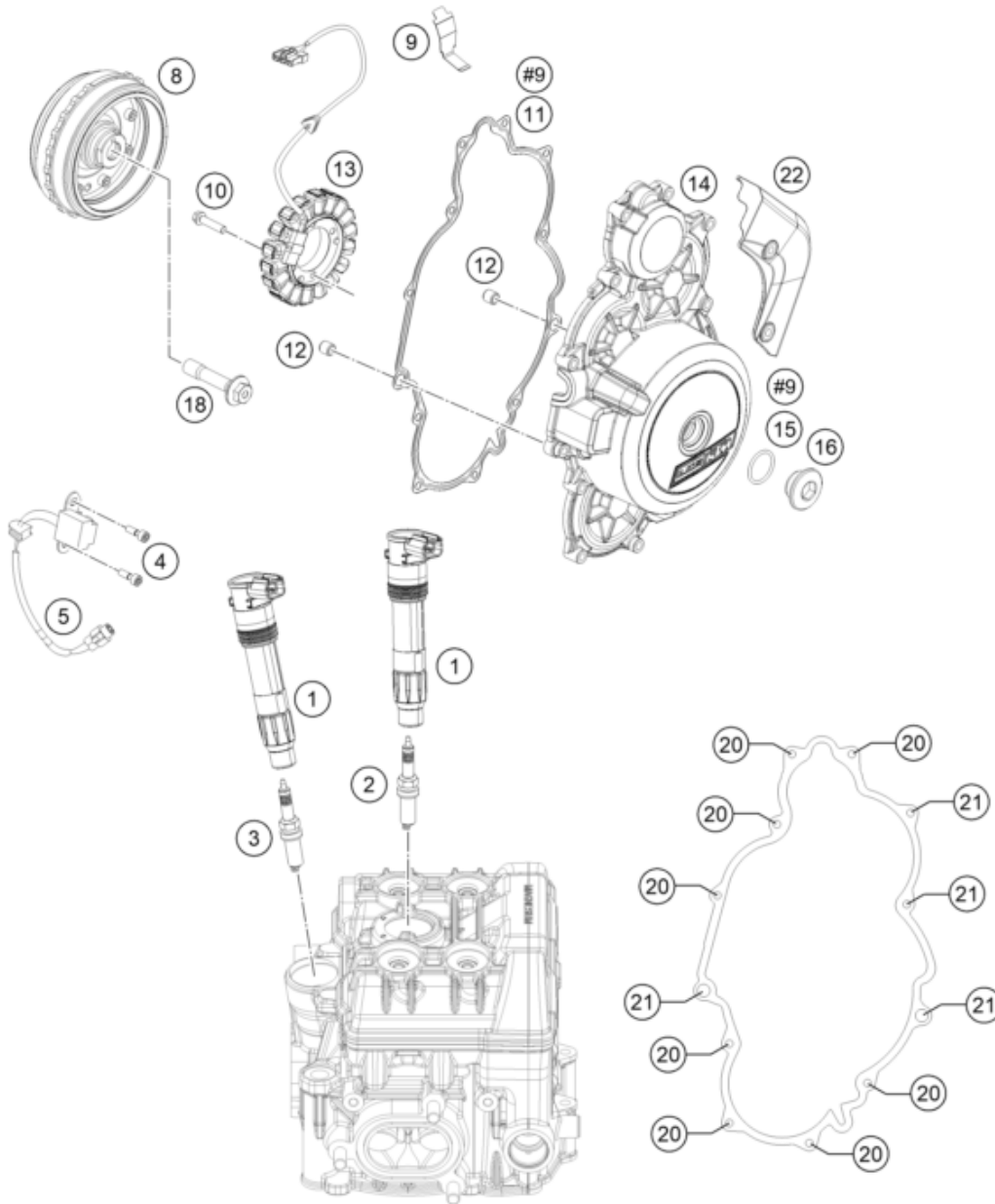

| Pos | Part Number | Description | Additional Text | Quantity |
|-----|---------------|--------------------------------|-----------------|----------|
| 1 | 76039006000 | STICK COIL | | 4.00 |
| 2 | 60439093000 | SPARK PLUG M12X1.25 | | 2.00 |
| 3 | 60439094000 | SPARK PLUG | | 2.00 |
| 4 | 60339035000 | SPECIAL SCREW M5X16 | | 2.00 |
| 5 | 59039034000 | pulse generator KOKUSAN 4K3-A/ | | 1.00 |
| 8 | 61539005000 | Rotor complete | | 1.00 |
| 9 | 60039040020 | generator line bracket | | 1.00 |
| 10 | 0025060256S | SK-BUNDSCHRAUBE M6X25 ISA30 | | 4.00 |
| 11 | 61230040100 | GASKET GENERATORCOVER | | 1.00 |
| 12 | 49030090000 | DOWEL 9,8 X 7 X 10 | FS-E | 2.00 |
| 13 | 60339004000 | STATOR | | 1.00 |
| 14 | 6023010214441 | IGNITION COVER WITH BEARINGS | | 1.00 |
| 15 | 07700240251 | o-ring 24.00x2.50 Viton | | 1.00 |
| 16 | 6003009400030 | threaded plug M24x1.5 PA 6.6 | | 1.00 |

| | | | | |
|----|-------------|----------------------------|--|------|
| 18 | 60339003000 | special screw M12x1.5 WS15 | | 1.00 |
| 20 | 0025060306 | HH collar screw M6x30 TX30 | | 8.00 |
| 21 | 0025060356 | HH collar screw M6x35 TX30 | | 4.00 |
| 22 | 61411095000 | Plug cover | | 1.00 |