

#9 ENTHALTEN IM DICHTSATZ MOTOR KPL.
INCLUDED IN GASKET-SET ENGINE CPL.

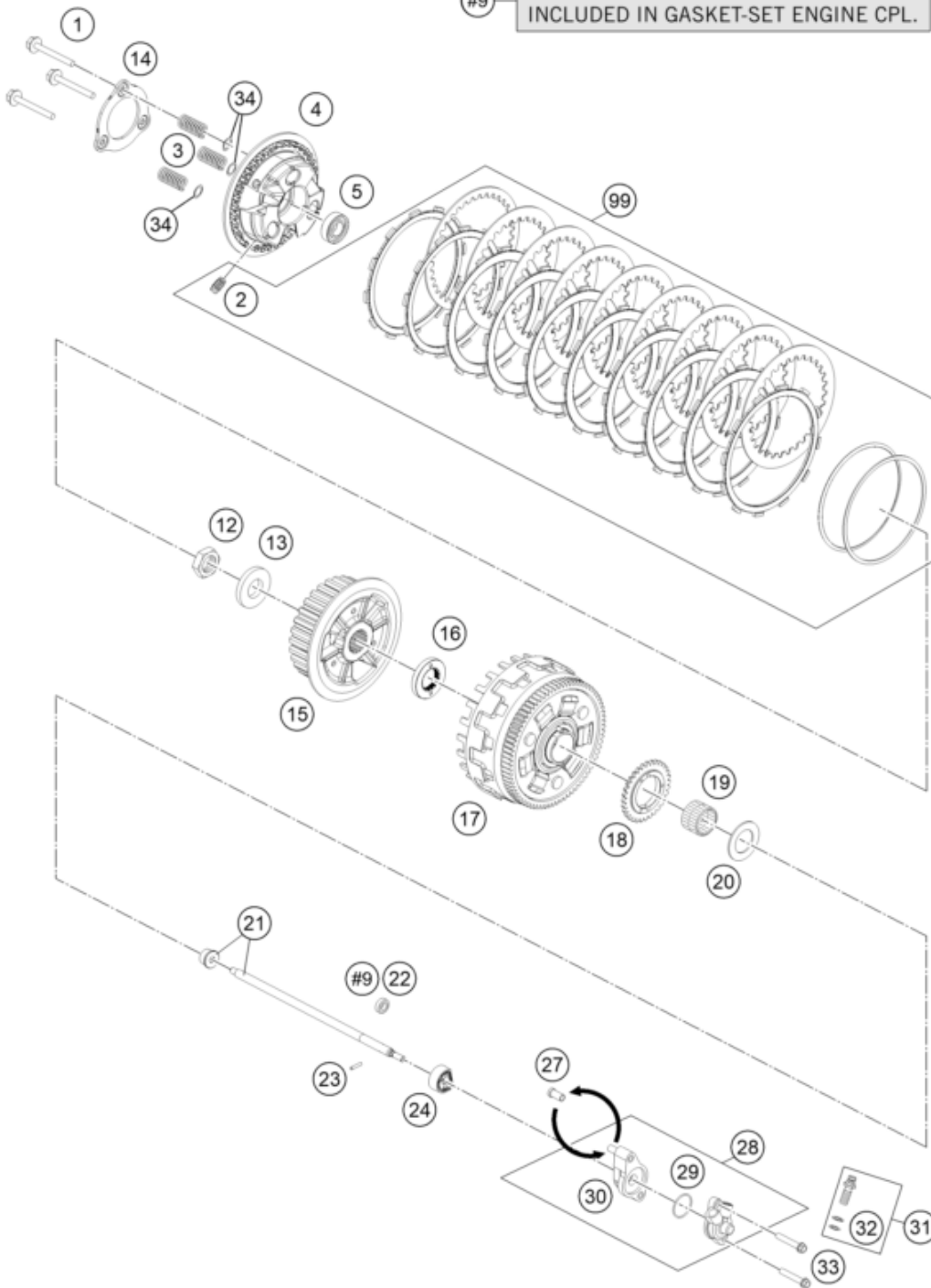

| Pos | Part Number | Description | Additional Text | Quantity |
|-----|-------------|--------------------------------|-----------------|----------|
| 1 | 61332044000 | HH collar screw M6X45 WS10 | | 3.00 |
| 2 | 61332007000 | DAMPER | | 3.00 |
| 3 | 61332005000 | CLUTCH SPRING | | 3.00 |
| 4 | 61332003000 | PRESSURE CAP | | 1.00 |
| 5 | 0625060032 | BALL BEARING 6003 JR2 C4 | | 1.00 |
| 12 | 0936220155 | HEXAGON NUT DIN0936-M22X1,5 R. | | 1.00 |
| 13 | 0126220373 | WASHER DIN0126 22X37X3 MM | | 1.00 |
| 14 | 61332006000 | ARRESTOR PRESSURE CAP | | 1.00 |
| 15 | 61332002000 | INNER CLUTCH HUB | | 1.00 |
| 16 | 60032021000 | SECTION WASHER 03 | | 1.00 |
| 17 | 61332001044 | CLUTCH CAGE CPL. | | 1.00 |

| | | | | |
|-----|-------------|--------------------------------|---------------------------|------|
| 18 | 60038001132 | oil pump gear 32 teeth | | 1.00 |
| 19 | 0618303526 | Needle bushing HK 30X35X26 | | 1.00 |
| 20 | 60032020000 | STOP DISK 30,2/50/2 | | 1.00 |
| 21 | 60232054000 | PUSH ROD CPL. 110MM | | 1.00 |
| 22 | 0760091862 | SHAFT SEAL RING 9X18X06 B-NBR | | 1.00 |
| 23 | 0402031780 | Needle roll.DIN5402 NRB 3X17.8 | | 1.00 |
| 24 | 61232069000 | PUSH ROD GUIDE | | 1.00 |
| 27 | 61232061051 | SLEEVE CLUTCH CONTR. | | 2.00 |
| 28* | 60032061344 | SLAVE CYLINDER CPL. LC8 DOT | | 1.00 |
| 29 | 60032065000 | O-RING GASKET 03 | | 1.00 |
| 30 | 60032061050 | DISTANCE CLUTCH CONTR. CPL. | | 1.00 |
| 31 | 50332062000 | Hollow screw cpl. M 10x1 98 | | 1.00 |
| 32 | 0603100141 | sealing ring DIN 7603 10x14x1 | ONLY FOR LC4 ADVENTURE | 2.00 |
| 33 | 0025060456 | HH COLLAR SCREW M6X45 TX30 | | 2.00 |
| 34 | 61332004000 | SUPPORT CLUTCH SPRING | | 3.00 |
| 99 | 60432011010 | CLUTCH KIT 1190/1290 | | 0.00 |

* = New part