

NUR FÜR 625 SUPERCOMPETITION
ONLY FOR 625 SUPERCOMPETITION

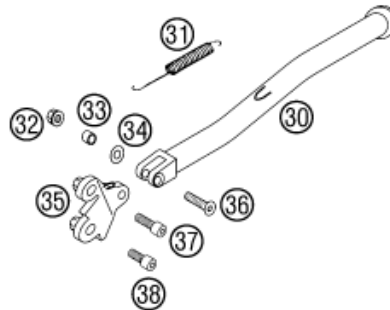

Pos	Part Number	Description	Additional Text	Quantity
1*	5841201020030	BAGGAGE CARRIER BLACK MIL LC4		1.00
2	58412011100	BUSH FOR BAGGAGE CARRIER 2000		2.00
3	0991060203	FLAT H.SCREW DIN7991-M6X20		2.00
4	40006006000	WASHER 6MM		2.00
5	56509064100	Self locking nut M6 - 10		2.00
9*	0912060353	AH SCREW DIN0912-M 6X35		2.00
20*	58314068000	BATTERY F. SPEEDOM. M.A.E. 02	TYPE CR 2430	1.00
21*	58314069350	* BRACKET TRIPMASTER SWITCH 02	ADAPTER LIGHT SWITCH - EU	1.00
22*	58314069200	TRIPMASTER-SWITCH DIGI-SPEEDO.		1.00
23*	0963040203	FLAT HEAD SCREW DIN0963-M 4X20		1.00
25*	6000207900030	% HAND GUARD L/S+R/S CPL. BLAC		1.00
25*	6000207900004	Handguard L/R cpl. orange		0.00
30	5830302320090	SIDESTAND SILVER L=381MM '99	625 SC	1.00
31	51003021000	SIDESTAND SPRING LONG		1.00
32	54310086200	Self locking nut M8 10.9		1.00

33	57103225000	BUSHING 8,2 X 12 X 10		1.00
34	54603025000	WASHER 12,5 X 25 X 1,5		1.00
35	58303026250	SIDE STAND BRACKET '97		1.00
36	0991080353	FLAT HEAD SCREW DIN7991-M 8X35		1.00
37	0912100303	AH SCREW DIN0912-M10X30		1.00
38	0912100256	AH SCREW DIN0912-M10X25 10.9		1.00
90*	58412099044	SKID PLATE LIMITED CPL. 97	ALUMINUM	1.00
92	0014060153	HH COLLAR SCREW M 6X15 WS=8		5.00
93	58003012200	ENGINE PROTECTOR BRACKET '97		2.00
94	54308042000	RUBBER BUFFER		4.00

* = New part