

DICHTUNGSSATZ KPL. 600.30.099.000
ENTHÄLT DICHT.SATZ ZYL.KOPF 600.30.097.000
GASKET-SET CPL. 600.30.099.000
INCL. GASKET-SET CYL. HEAD 600.30.097.000

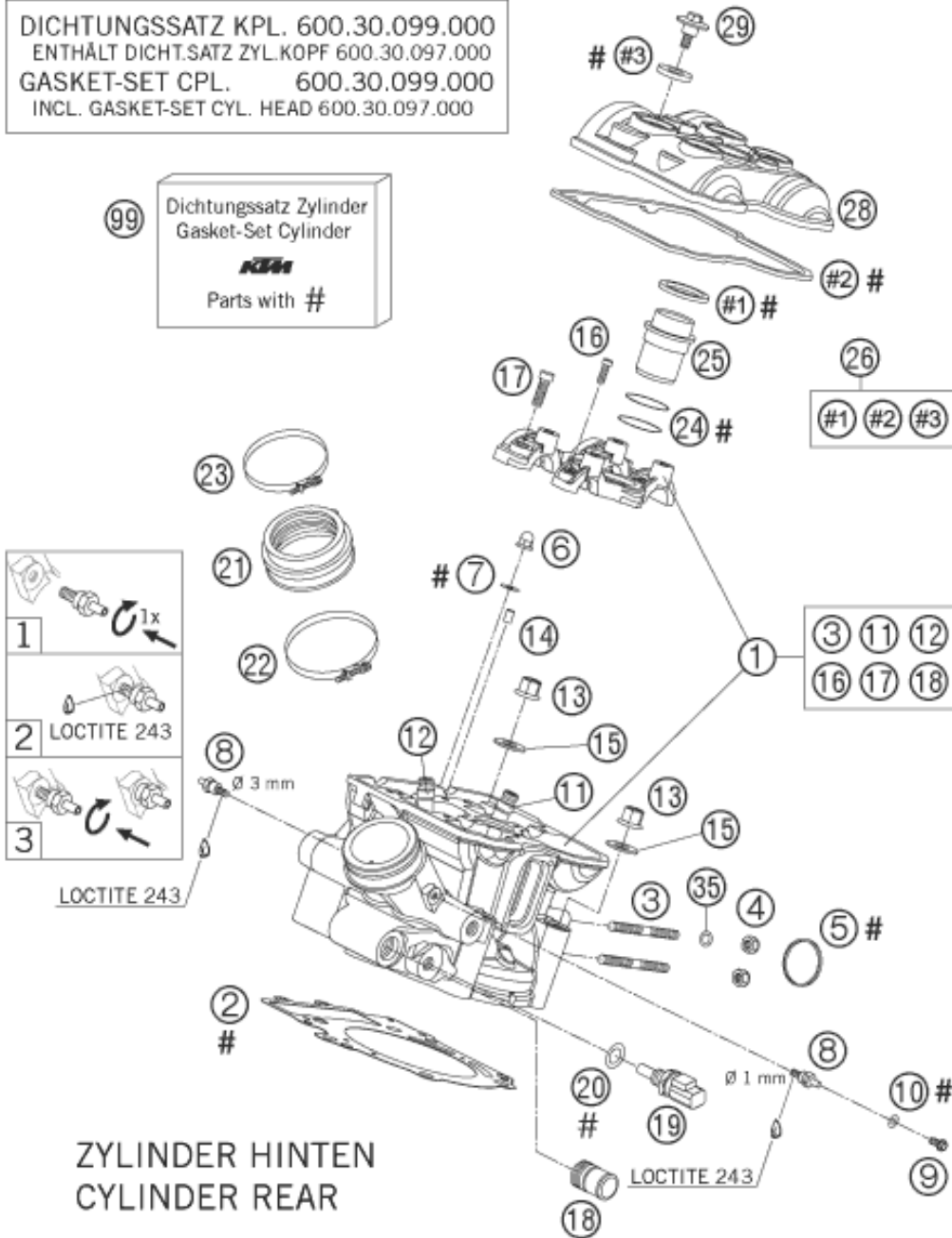

ZYLINDER HINTEN
CYLINDER REAR

| Pos | Part Number | Description | Additional Text | Quantity |
|-----|-------------|--------------------------------|----------------------|----------|
| 1* | 60036120044 | CYLIDNER HEAD CPL. REAR 03 | | 1.00 |
| 2 | 60030036000 | CYLINDER HEAD GASKET 0,5 101MM | | 1.00 |
| 3 | 0835080165 | STUD M 8X16 10.9 | | 2.00 |
| 4 | 51010086100 | self-locking nut M8 Cu | | 2.00 |
| 5 | 60005005000 | GASKET 03 | | 1.00 |
| 6 | 0587060000 | CAP NUT M6 DIN1587 02 | | 2.00 |
| 7 | 0125060003 | WASHER DIN0125-A 6,4 | | 2.00 |
| 8 | 58336020190 | VACUUM CONECTION M6/3MM '97 | SECONDARY AIR SYSTEM | 0.00 |
| 8* | 60036023000 | VACUUM CONECT. M6/1MM M-GROOVE | | 0.00 |
| 9 | 0015060103 | HH COLLAR SCREW M 6X10 WS=8 | FC | 0.00 |
| 10 | 0603061001 | CU-SEAL RING DIN7603-6X10X1 | | 0.00 |
| 11 | 60036026000 | VALVE GUIDE EXHAUST 03 | | 2.00 |
| 12 | 60036025000 | VALVE GUIDE INTAKE 03 | | 2.00 |

| | | | | |
|-----|-------------|--------------------------------|---------------------------|------|
| 13* | 60036078200 | hex collar nut M10 WS13 | | 4.00 |
| 14 | 0402050980 | needle roller DIN 5402 5x9.8 | | 2.00 |
| 15* | 60036078050 | SHIM 10,2X19X1,5MM 05 | | 4.00 |
| 16 | 0912060255 | AH SCREW DIN0912-M 6X25 10.9 | | 4.00 |
| 17 | 0984080305 | AH SCREW DIN7984-M 8X30 10.9 | | 4.00 |
| 18* | 58030010100 | HOSE CONNECTOR M20X1,5 SPLICE | | 1.00 |
| 19 | 60011252000 | TEMPERAT.-SENSOR WATER LC8 02 | ONLY FOR LC4 ADVENTURE | 1.00 |
| 20 | 0770100020 | o-ring 10.00x2.00 silicone | ONLY FOR LC4 ADVENTURE | 1.00 |
| 21 | 60036044000 | INTAKE BOOT 03 | | 1.00 |
| 22 | 60036047100 | HOSE CLAMP GEMI 62 MM 03 | | 1.00 |
| 23 | 59030061100 | HOSE CLAMP GEMI 56MM 03 | | 1.00 |
| 24 | 0770298178 | O-RING 29,87X1,78 VITON | | 2.00 |
| 25 | 60036075000 | INSERT SPARK-PLUG SHAFT LC8 03 | | 1.00 |
| 26 | 60036099000 | VALVE COVER GASKET SET FR+RR | | 1.00 |
| 28 | 60036152000 | VALVE COVER REAR 03 | | 1.00 |
| 29 | 60036052020 | collar screw M 6 WS=10 03 | | 4.00 |
| 35 | 0125080003 | washer DIN 125 A -8.4 | | 1.00 |
| 99 | 60030097000 | GASKET SET CYL. HEAD KPL. 03 | CYLINDER FRONT + REAR | 1.00 |

* = New part