

**ACHTUNG !**  
 Bei Bestellung von Getrieberädern, Markierung beachten.

**CAUTION !**  
 When you order transmission gears, check marking.

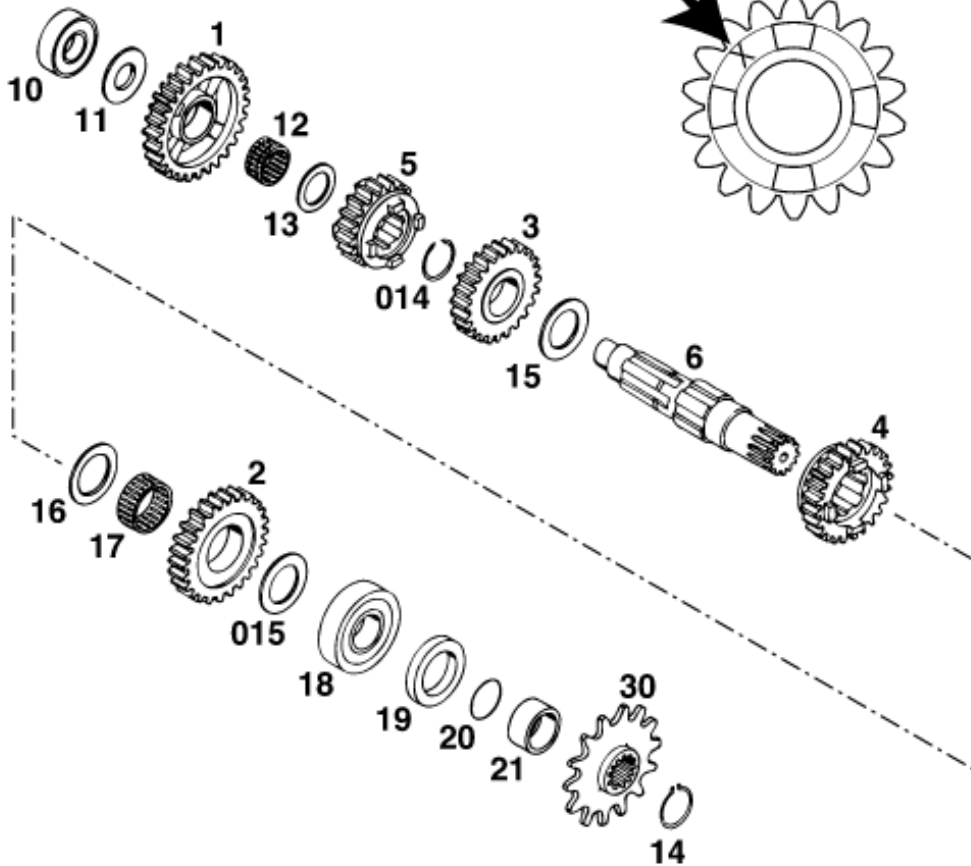
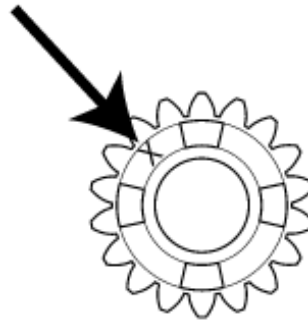

Pos	Part Number	Description	Additional Text	Quantity
1	54633005000	IDLER GEAR 1ST GEAR 29-T "430		1.00
2	54633013000	2ND GEAR COUNTERSH.27-T "450'	250 SX	1.00
2	54633113000	IDLER GEAR 2ND GEAR 26-T "455	250/300/380 EXC,380SX,300 MXC	1.00
3	54633009000	3RD GEAR COUNTERSH.25-T "470'	250 SX	1.00
3	54633009100	IDLER GEAR 3RD GEAR 24-T "472	380 SX, 300 MXC	1.00
3	54633109000	IDLER GEAR 3RD GEAR 22-T "475	250/300/380 EXC	1.00
4	54633011000	SLIDING GEAR 4TH G. 23-T "490	250/380 SX, 300 MXC	1.00
4	54633111000	SLIDING GEAR 4TH G. 20-T "495	250/300/380 EXC	1.00
5	54633007300	SLIDING GEAR 5TH G. 21-T "512	250/380 SX, 300 MXC	1.00
5	54633107300	SLIDING GEAR 5TH G. 18-T "517	250/300/380 EXC	1.00
6	54633003400	COUNTER SHAFT '93		1.00
10	0625062031	BALL BEARING 6203 TN9.C3		1.00
11	54633018000	STOP DISK 17,2X34X1,5		1.00
12	56533099000	NEEDLE BEAR. K22X26X13 DIVID		1.00
13	54633017000	STOP DISK 22,2X33X1,5		1.00

14	52033096000	LOCK RING DIN0471-25X1,64SD		1.00
14	54633196000	AXIAL CIRCLIP 25X2,0		1.00
15	54633020000	STOP DISK 25,6X40X1,5		1.00
15	54633020400	STOP DISK 26,1X40X1,5		1.00
16	54633019000	STOP DISK 28,2X40X1,5		1.00
17	54633098000	NEEDLE BEARING K 28X33X13 B		1.00
18	0625613742	BALL BEARING 613742 C4		1.00
19	0760324271	SHAFT SEAL RING 32X42X7 BSL		1.00
20	0770250020	O-RING 25,00X2,00 NBR 70		1.00
21	54633014100	SPACER BUSHING 12MM	ONLY FOR 640 DUKE	1.00
30	50033029013	FRONT SPROCKET 13-T		1.00
30	50033029014	FRONT SPROCKET 14-T		1.00
30	50033029015	FRONT SPROCKET 15-T		1.00