

FÜLLMENGE: 330CCM STOSSDÄMPFERÖL SAE5 PRO GABELHOLM
OIL QUANTITIES: 330 CCM SHOCK ABSORBER OIL SAE5 PER FORK LEG

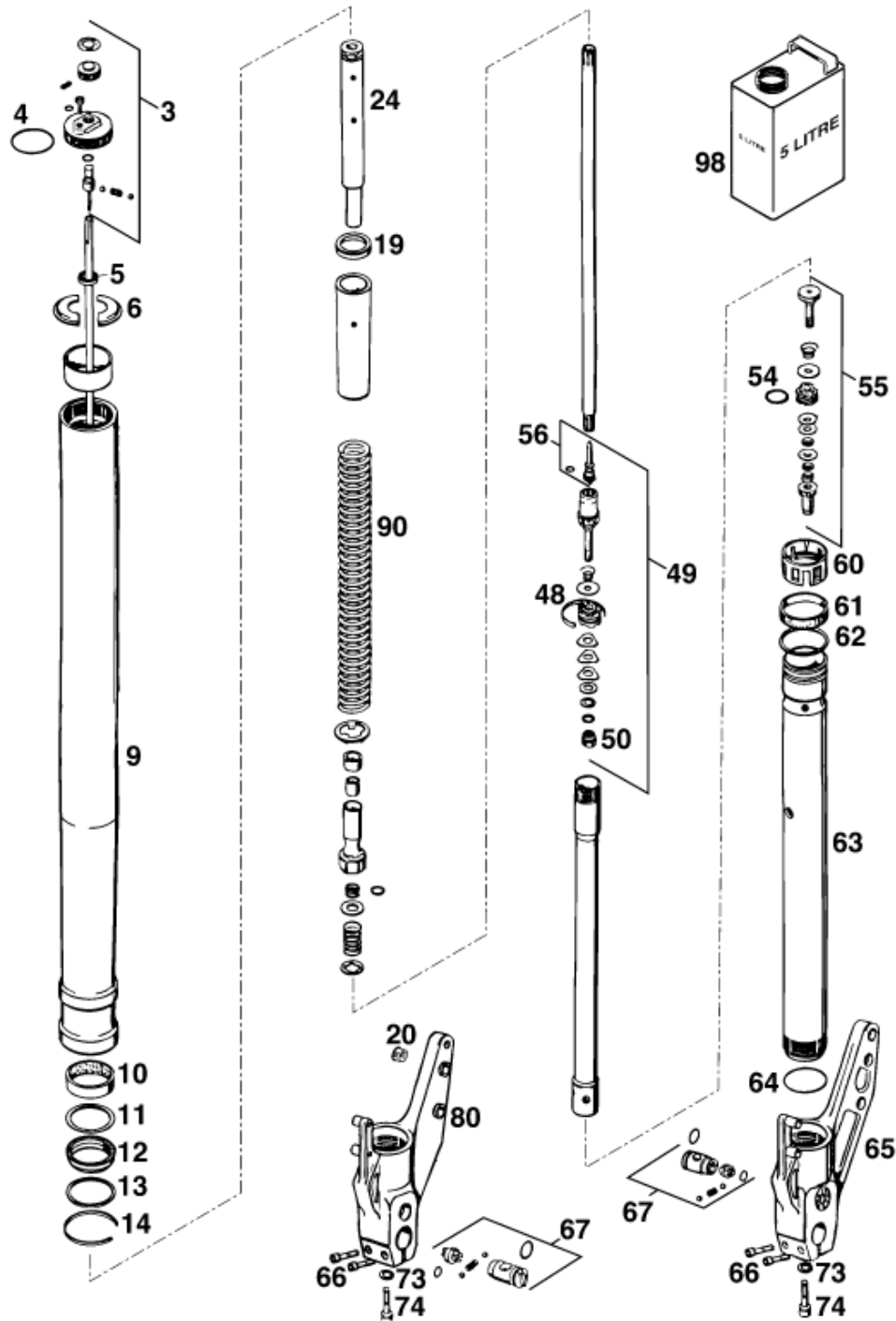

Pos	Part Number	Description	Additional Text	Quantity
3	57601036044	SCREW CAP CPL.IBS '94		2.00
4	0770430030	O-RING 43,00X3,00		2.00
5	54501051000	* RUBBER GASKET 14,1X22X4		2.00
6	56501450200	% KEY IBS		4.00
9*	58301004000	* OUTER TUBE DUKE'94		2.00
10	57501026000	GUIDE BUSHING 40 X 44 X 20-1		2.00
11	56401027000	RING 42X49,2X1,5		2.00
12	58001805000	SHAFT SEAL RING 40X49,5X9LF		2.00
13	56401127000	RING 49,5X45X1		2.00

14	56401029000	SEEGER LOCK RING SB50		2.00
19	54501019000	WASHER 24,5X34X2		2.00
20*	58301098000	PLASTIC CAP 3/8" 2663		2.00
24	56501457244	HYDROSTOP CPL IBS L=227,5 MM		2.00
48	57601070000	* PISTON RING 5X1X62		2.00
49*	58301271044	REBOUND DAMPING CPL. DUKE'94		2.00
50	54501072000	* HEX.NUT M6X0,5		2.00
54	0770020160	O-RING 15,60X1,78		2.00
55*	58301276044	COMPRESS DAMPING CPL. DUKE'94		2.00
56	56501467244	* ADJUSTMENT SCREW CPL IBS '93		2.00
60	54501077000	BUSHING		2.00
61*	54501045000	ANILLO DE RODAMIENTO 42,8X13		2.00
62	54501046000	% RING 39X42X1		2.00
63*	58301203000	% INNER TUBE L=520MM DUKE'		2.00
64	0770380020	O-RING 38,00X2,00 NBR 70 SH		2.00
65*	58301206000	% AXLE CLAMP L/S DUKE '94		1.00
66	0912080303	AH SCREW DIN0912-M 8X30		4.00
67	54501078144	% ADJUSTMENT SCREW COMP.DAMPIN		2.00
73	54501081000	SEAL RING 8X12X1,5		2.00
74	0984080203	* AH SCREW DIN7984-M 8X20		2.00
80*	58301306000	% AXLE CLAMP R/S DUKE'94		1.00
90*	58301221900	* SPRING 400MM 6,5/9,0 KG		2.00
98*	306007	FORK OIL SAE5 5 LITER		1.00

* = New part