

**ACHTUNG !!!**  
Bei Bestellung von Getrieberädern, Markierung beachten.  
**CAUTION !!!**  
When ordering transmission gears, check marking.

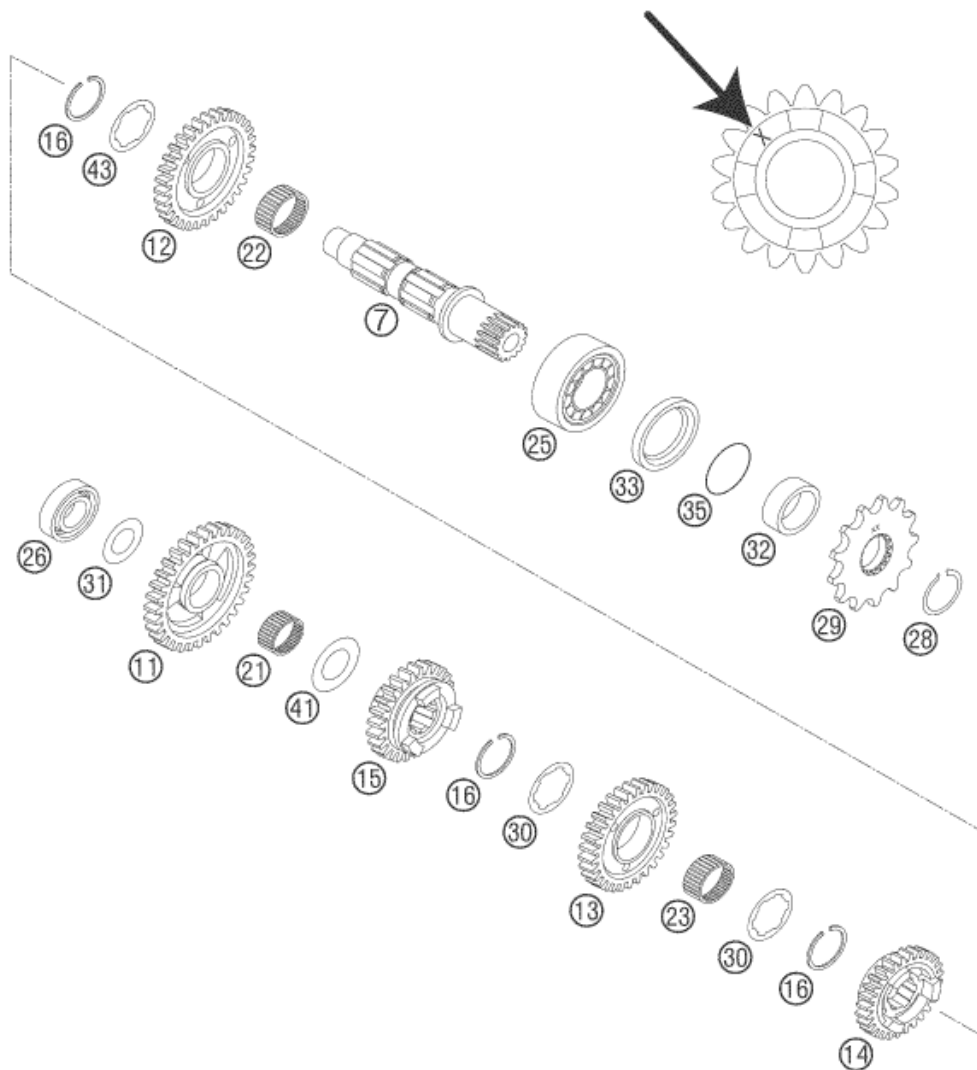

Pos	Part Number	Description	Additional Text	Quantity
7	54833007000	COUNTERSHAFT 2003		1.00
11	54833111000	IDLER GEAR 1ST G. 30-T "1E30'		1.00
12	54833112000	IDLER GEAR 2ND G. 26-T "2E26'		1.00
13	54833113000	IDLER GEAR 3RD G. 23-T "3E23'		1.00
14	54833114000	SLIDING GEAR 4TH G.20-T "4E20		1.00
15	54833115000	SLIDING GEAR 5TH G.23-T "5E23		1.00
16	77033022000	AXIAL-CIRCLIP 25X1,65		3.00
21	0405202413	NEEDLE BEAR. K20X24X13		1.00
22	0405242812	NEEDLE BEAR. K24X28X11,9 DIV.		1.00
23	0405222613	NEEDLE BEAR. K 22X26X13 TN		1.00
25	54833025000	BALL BEARING TM-SC05C20C4 NTN		1.00
26	0625062035	BALL BEARING 6203 JR2 C3		1.00
28	52033096000	LOCK RING DIN0471-25X1,64SD		1.00
29	50033029013	FRONT SPROCKET 13-T		0.00

29	50033029014	FRONT SPROCKET 14-T		0.00
29	50033029015	FRONT SPROCKET 15-T		0.00
30	59033030000	STOP DISC 25,2X32X1,5		2.00
31	56033030000	STOP DISC 17,2X30X1		1.00
32	54833032011	spacer sleeve drive end		1.00
33	0760324565	SHAFT SEAL RING 32X45X6,5		1.00
35	0770248022	O-RING 24,80X2,20 P431 NBR 70		1.00
41	59033080000	Shim 20x31.9x1		1.00
43	50333043000	STOP DISC 25,2X32X1		1.00