

**ACHTUNG !!!**  
 Bei Bestellung von Getrieberädern, Markierung beachten.  
**CAUTION !!!**  
 When ordering transmission gears, check marking.

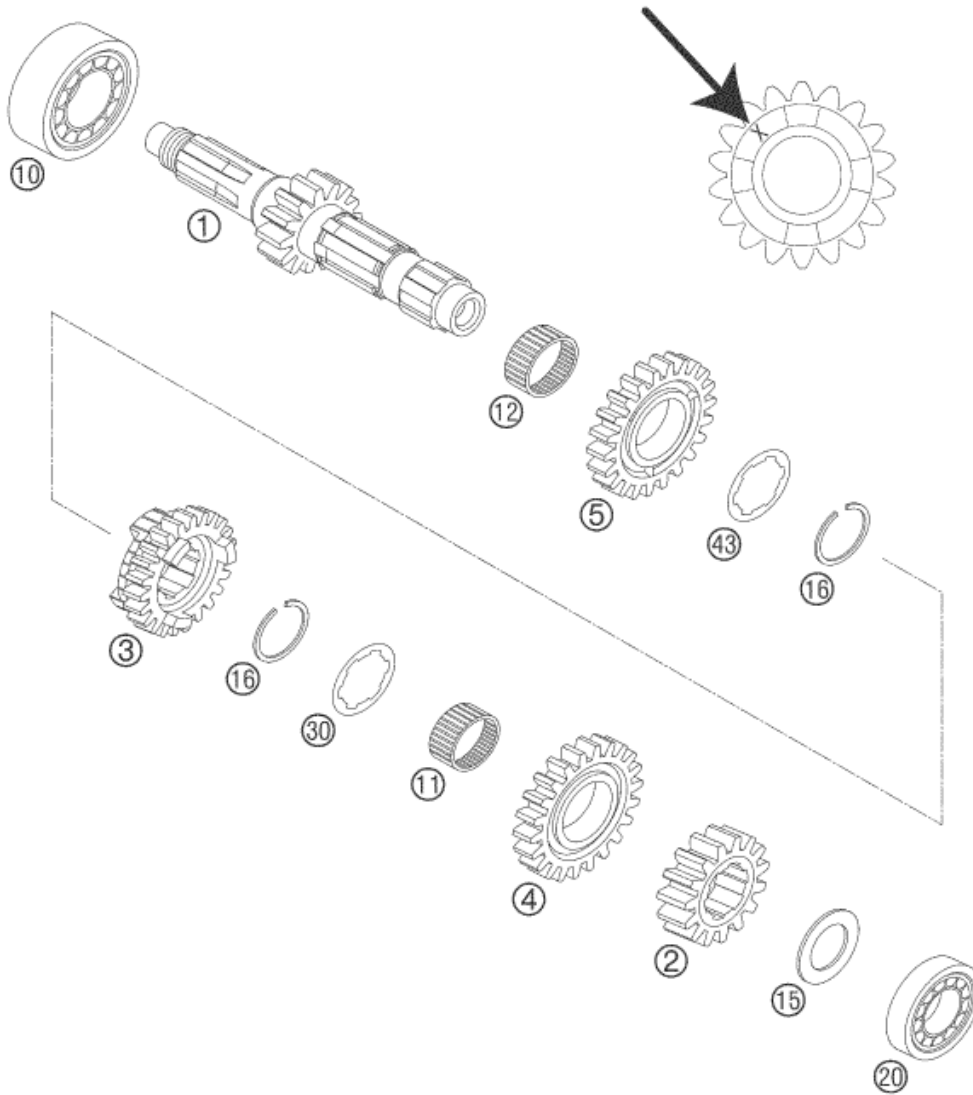

| Pos | Part Number | Description                     | Additional Text | Quantity |
|-----|-------------|---------------------------------|-----------------|----------|
| 1   | 54833101000 | MAIN SHAFT 14-T "1E14"          |                 | 1.00     |
| 2   | 54833102000 | SOLID GEAR 2ND G. 17-T "2E17"   |                 | 1.00     |
| 3   | 54833103000 | SLIDING GEAR 3RD G. 19-T "3E19" |                 | 1.00     |
| 4   | 54833104000 | IDLER GEAR 4TH G. 20-T "4E20"   |                 | 1.00     |
| 5   | 54833105000 | IDLER GEAR 5TH G. 29-T "5E29"   |                 | 1.00     |
| 10  | 0625062054  | BALL BEARING 6205 C3 NTN        |                 | 1.00     |
| 11  | 0405222613  | NEEDLE BEAR. K 22X26X13 TN      |                 | 1.00     |
| 12  | 0405242812  | NEEDLE BEAR. K24X28X11,9 DIV.   |                 | 1.00     |
| 15  | 54633015000 | STOP DISK 20,2X33X1,5           |                 | 1.00     |
| 16  | 77033022000 | AXIAL-CIRCLIP 25X1,65           |                 | 2.00     |
| 20  | 0625160040  | GROOVED BALL BEAR. TM 16004 C3  |                 | 1.00     |
| 30  | 59033030000 | STOP DISC 25,2X32X1,5           |                 | 1.00     |
| 43  | 50333043000 | STOP DISC 25,2X32X1             |                 | 1.00     |