

**ACHTUNG !!!**  
 Bei Bestellung von Getrieberädern, Markierung beachten.  
**CAUTION !!!**  
 When ordering transmission gears, check marking.

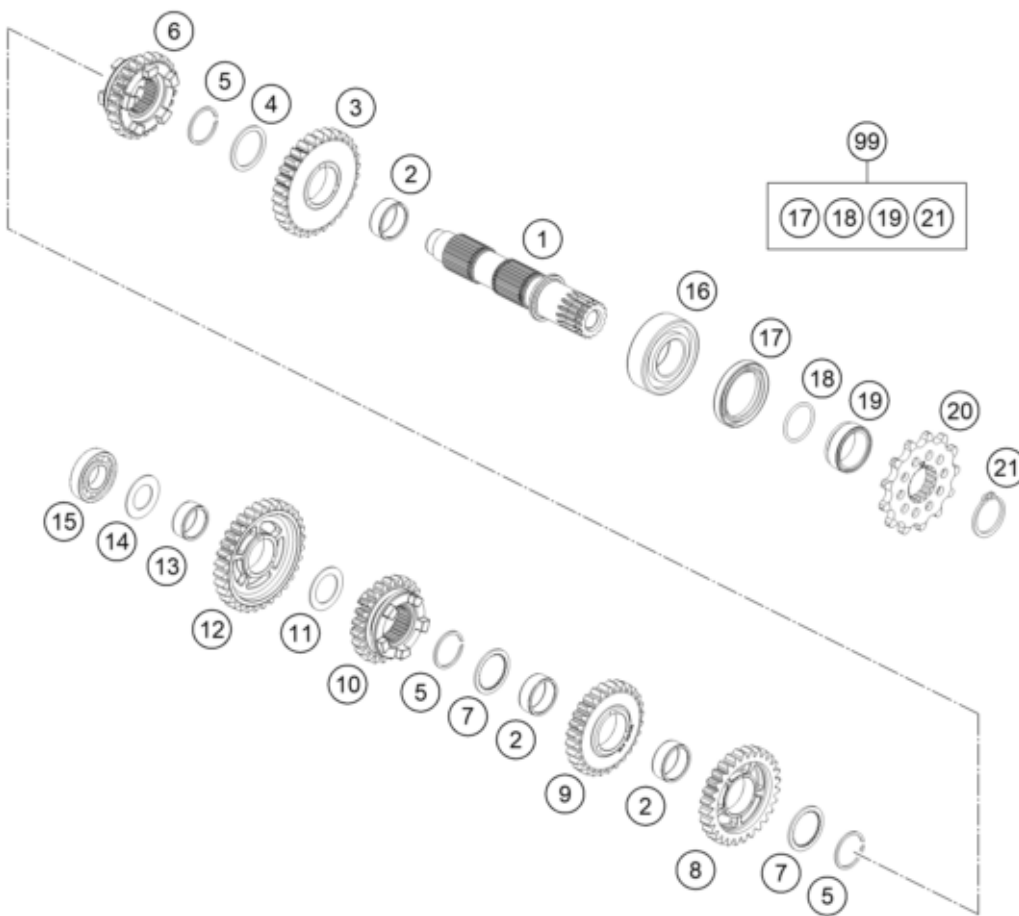

Pos	Part Number	Description	Additional Text	Quantity
1	50433010000	DRIVEN SHAFT CPL.		1.00
2	0405222611	NEEDLE BEAR.K 22X26X10 DIVIDED		3.00
3	50433012000	IDLER GEAR, 2ND GEAR, 30T		1.00
4	54833044000	STOP DISC 25X31X1,5		1.00
5	0417024000	CIRCLIP WS24		3.00
6	50433016000	SLIDING GEAR, 6TH GEAR, 24T		1.00
7	54833043000	STOP DISC 25X0,8X30X30X7H		2.00
8	50433013000	IDLER GEAR, 3RD GEAR, 28T		1.00
9	50433014000	IDLER GEAR, 4TH GEAR, 28T		1.00
10	50433015000	SLIDING GEAR, 5TH GEAR, 23T		1.00
11	54833080000	STOP DISC 20,2X30X1		1.00

12	50433011000	IDLER GEAR, 1ST GEAR, 32T		1.00
13	0405202410	NEEDLE BEARING K20X24X10		1.00
14	56033030000	STOP DISC 17,2X30X1		1.00
15	0625160031	GROOVED BALL B. 16003 C4 J1		1.00
16	0625062054	BALL BEARING 6205 C3 NTN		1.00
17	0760324571	SHAFT SEAL RING 32X45X7 BSLNBR		1.00
18	0770230020	O-RING 23,00X2,00 NBR70		1.00
19	50433030000	SPACER BUSHING 12,4 MM		1.00
20	79233029013	Sprocket 13-t		1.00
21	0471250200	CIRCLIP DIN0471 - 25X2		1.00
99	00050000949	COUNTER SHAFT REP. KIT 125 SX		0.00