

#9 ENTHALTEN IM DICHTSATZ MOTOR KPL.  
 INCLUDED IN GASKET-SET ENGINE CPL.

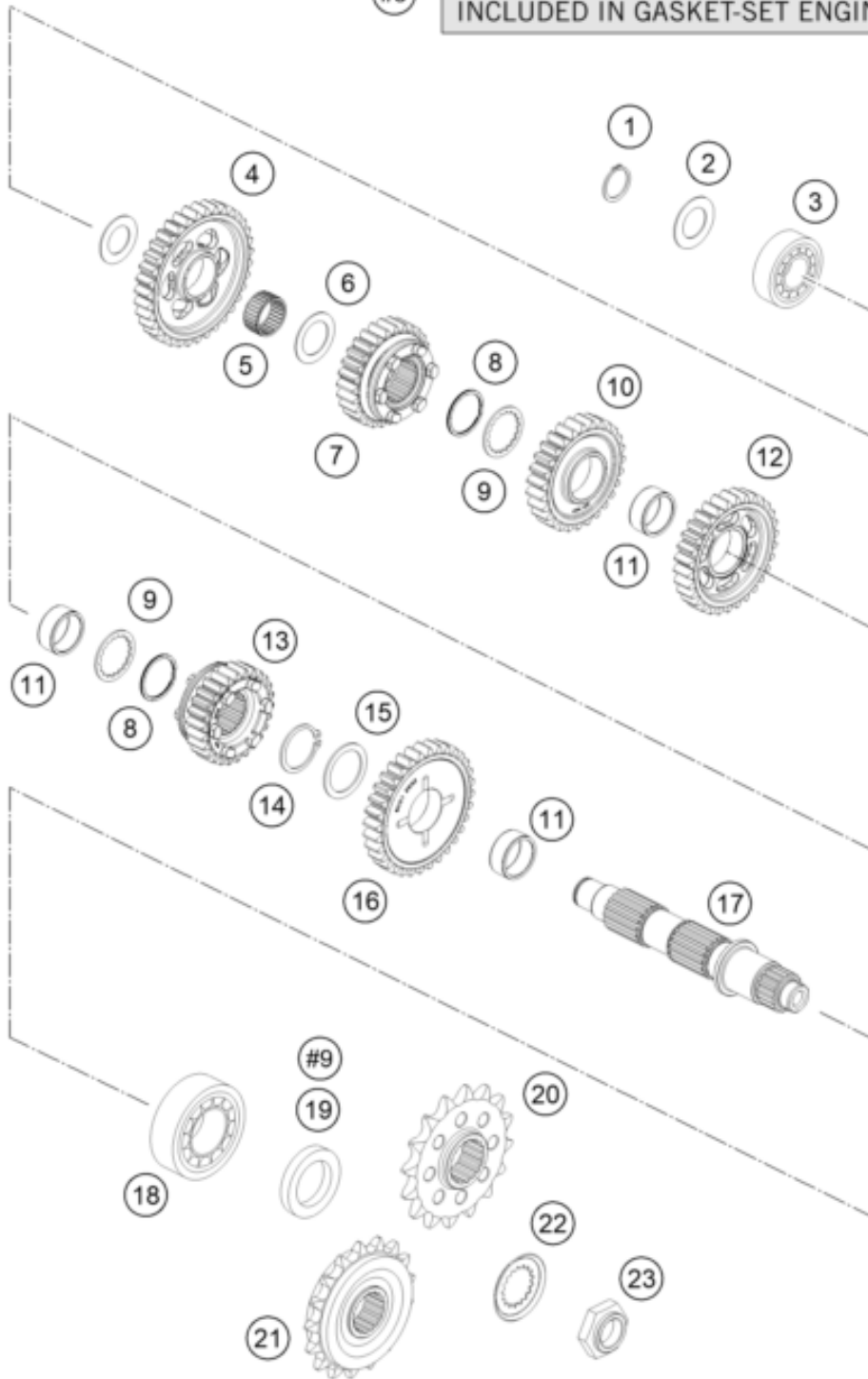

Pos	Part Number	Description	Additional Text	Quantity
1	0471200120	CIRCLIP DIN471 20X1,2		1.00
2	60033043000	STOP DISK 20,2 X 34 X 1		1.00
3	0625062043	BALL BEARING 6204 J1 C3		1.00
4	60333011100	IDLE GEAR 1. GEAR		1.00
5	0405242813	NEEDLE BEAR. K 24X28X13 TN	L-PART	1.00
6	60033044000	STOP DISK 24,3/35,75/1		1.00
7	60333015000	SLIDING GEAR 5.GEAR		1.00
8	0471029000	TWISTED CIRCLIP D29	L-PART	2.00
9	61233045000	STOP DISK 27/36/1,5		2.00

10	60333014000	IDLER GEAR 4. GEAR		1.00
11	0405263113	NEEDLE BEAR. K 26-31-13		3.00
12	60333013000	IDLER GEAR 3. GEAR		1.00
13	60333016000	SLIDING GEAR 6. GEAR		1.00
14	0471300151	CIRCLIP DIN0471-30X1,5 NIRO		1.00
15	61233046000	STOP DISK 29,9/39/1,5		1.00
16	60333012100	IDLE GEAR 2. GEAR		1.00
17	60333010000	COUNTERSHAFT		1.00
18	50330082000	CYL.ROLLER BEAR.NJ206 ET2XCS46		1.00
19	0760304772	SH.SEAL RING 30X47X7 BSL VITON		1.00
20	60033029017	CHAIN SPROCKET 17-T 03		0.00
21	60033129017	Chain sprocket 17-t, damped 0		1.00
22	60033034000	Securing plate toothed		1.00
23	60033035000	Hexagon nut M20x1.5 WS32		1.00