

# ENTHALTEN IM DICHTSATZ MOTOR LC4  
INCLUDED IN GASKET-SET ENGINE LC4

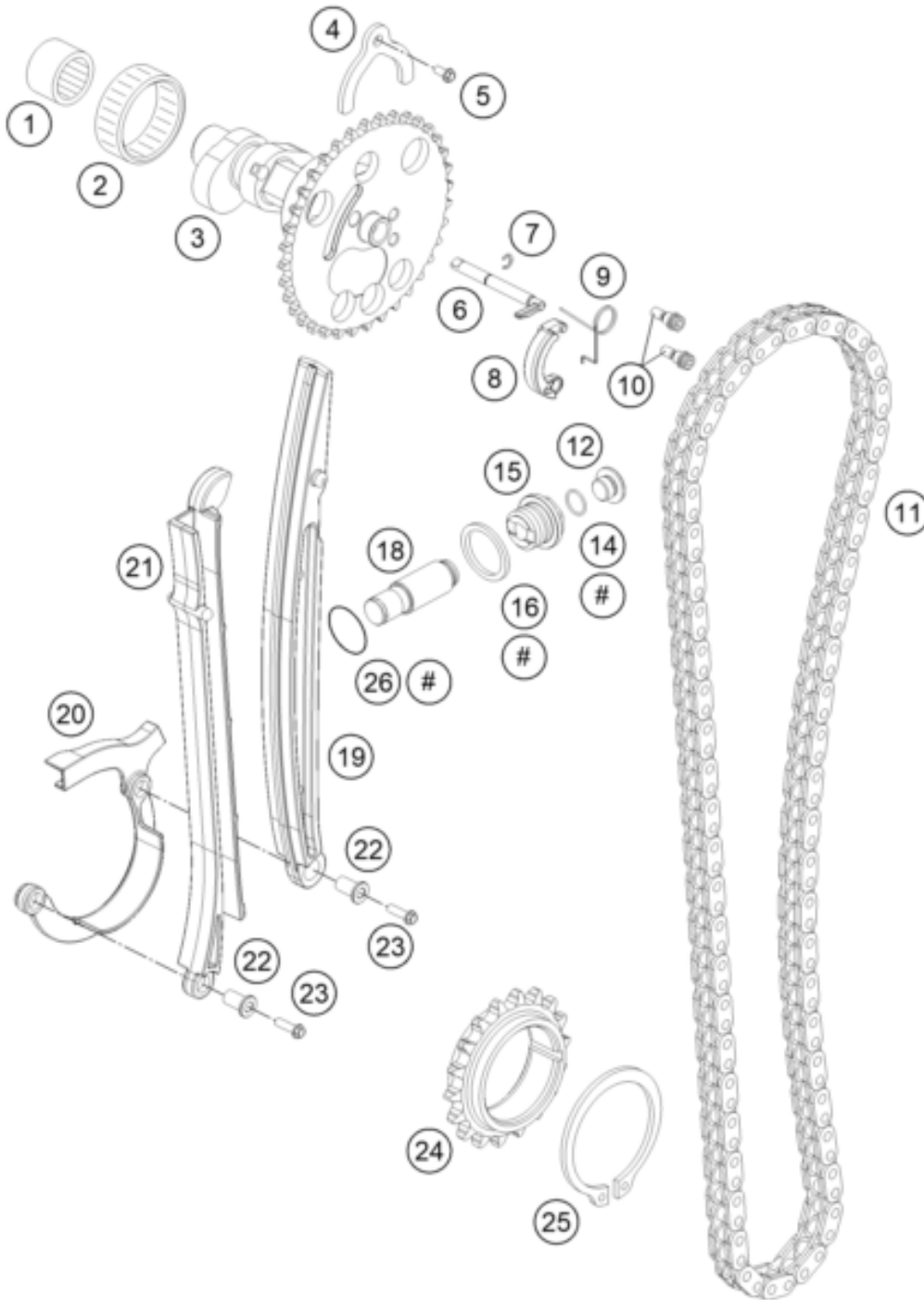

Pos	Part Number	Description	Additional Text	Quantity
1	0618182414	NEEDLE SLEEVE HK1814RS18/24/14		1.00
2	0618404712	NEEDLE SLEEVE HK4012B40X47X12		1.00
3	76536010100	CAMSHAFT		1.00
4	75036010050	CAMSHAFT HOLDER 07		1.00
5	0025060126	HH collar screw M6x12 TX30		1.00
6	75036016000	AUTO DECOMPRESSION 07		1.00
7	75036016050	HALF MOON RING H6-BLS 07		1.00
8	75036015000	AUTO DECO WEIGHT 07		1.00

9	75036017000	SPRING FOR AUTO DECOMPR. 07		1.00
10	75036019000	DECO SCREW 07		2.00
11	76036013000	TIMING CHAIN		1.00
12*	77236080000	SCREW PLUG		1.00
14	0770010010	o-ring 10.00x1.00 NBR70		1.00
15	75036008000	SCREW PLUG CHAIN ADJ. 07		1.00
16	0603202702	CU SEAL-RING 20X27X1		1.00
18	77036003000	CHAIN ADJUSTER HYD. 05		1.00
19	75036002000	TENSIONER RAIL 07		1.00
20	75036018000	SECURING GUIDE 07		1.00
21	75036001000	GUIDE RAIL 07		1.00
22	75036018050	SUPPORTING SLEEVE 07		2.00
23	0025060306S	HH collar screw M6x30 TX30		2.00
24	75036014100	TIMING PINION		1.00
25	0471300151	CIRCLIP DIN0471-30X1,5 NIRO		1.00
26	0770180020	o-ring 18.00x2.00 NBR70		1.00

\* = New part