

## EXHAUST

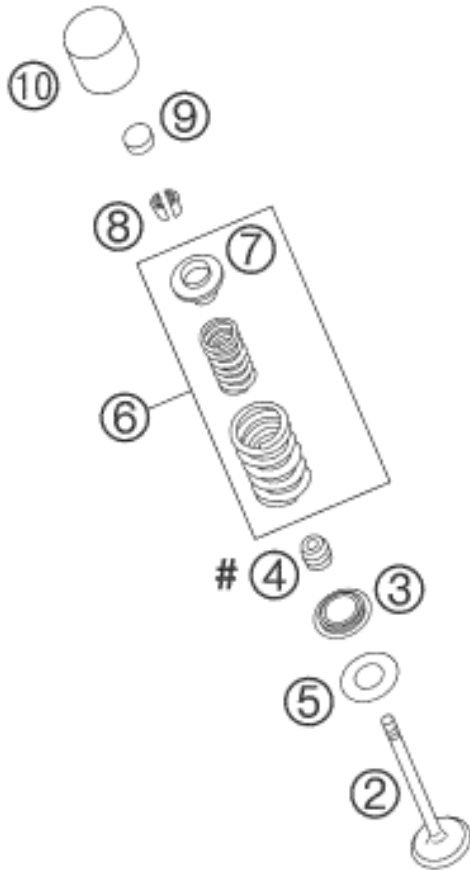

## INTAKE

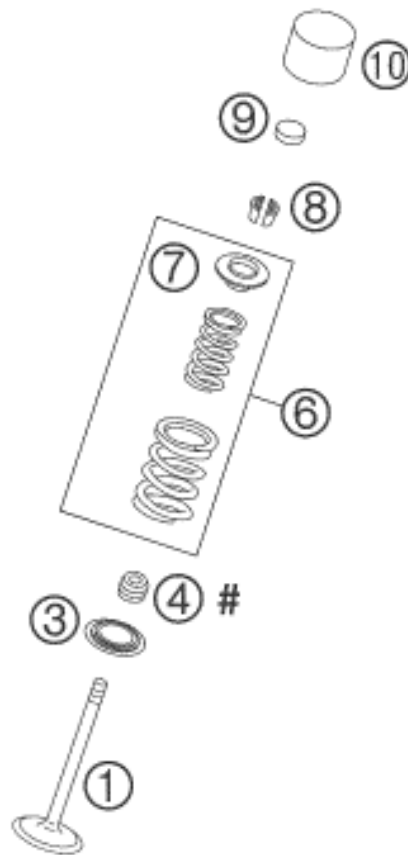

ENTHALTEN IM DICHTUNGSSATZ KPL.  
INCLUDED IN GASKET SET CPL.

600.30.099.000

ENTHALTEN IM DICHTUNGSSATZ ZYL.KOPF  
INCLUDED IN GASKET SET CYL. HEAD

600.30.097.000

#

Pos	Part Number	Description	Additional Text	Quantity
1	60036030000	INTAKE VALVE 03		4.00
2	60036031000	EXHAUST VALVE		4.00
3	60036036000	SPRING RETAINER 03		8.00
4	59036027000	VALVE-STEM SEALING RACING		8.00
5	60036037000	WASHER 14/30/2 03	EXHAUST	4.00
6	60036029044	VALVE SPRING KIT LC8 2003		8.00
7	60036032000	VALVE-SPRING RETAINER 03		8.00
8	60036033000	VALVE COLLET MK6 03		16.00
9	60036035230	SHIM D=10/2,30 03		0.00
9	60036035235	SHIM D=10/2,35 03		0.00
9	60036035240	SHIM D=10/2,40 03		0.00

9	60036035245	SHIM D=10/2,45 03		0.00
9	60036035250	SHIM D=10/2,50 03		0.00
9	60036035255	SHIM D=10/2,55 03		0.00
9	60036035260	SHIM D=10/2,60 03		0.00
9	60036035265	SHIM D=10/2,65 03		0.00
9	60036035270	SHIM D=10/2,70 03		0.00
9	60036035275	SHIM D=10/2,75 03		0.00
9	60036035280	SHIM D=10/2,80 03		0.00
9	60036035285	SHIM D=10/2,85 03		0.00
9	60036035290	SHIM D=10/2,90 03		0.00
9	60036035295	SHIM D=10/2,95 03		0.00
9	60036035300	SHIM D=10/3,00 03		0.00
9	60036035305	SHIM D=10/3,05 03		0.00
9	60036035310	SHIM D=10/3,10 03		0.00
9	60036035315	SHIM D=10/3,15 03		0.00
9	60036035320	SHIM D=10/3,20 03		0.00
9	60036035330	SHIM D=10/3,3		0.00
10	60036034000	BUCKET TAPPET 03		8.00