

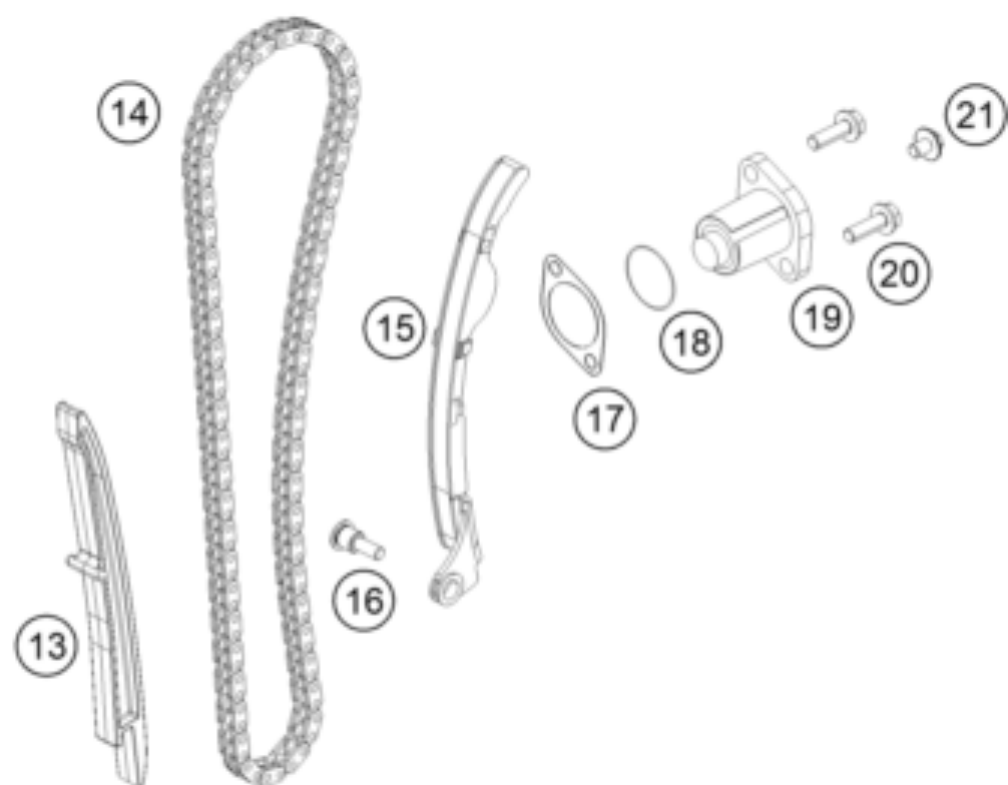

390 DUKE WHITE ABS CKD 2014 <2014><CO><F8341M7BC>  
TIMING DRIVE  
14075

---

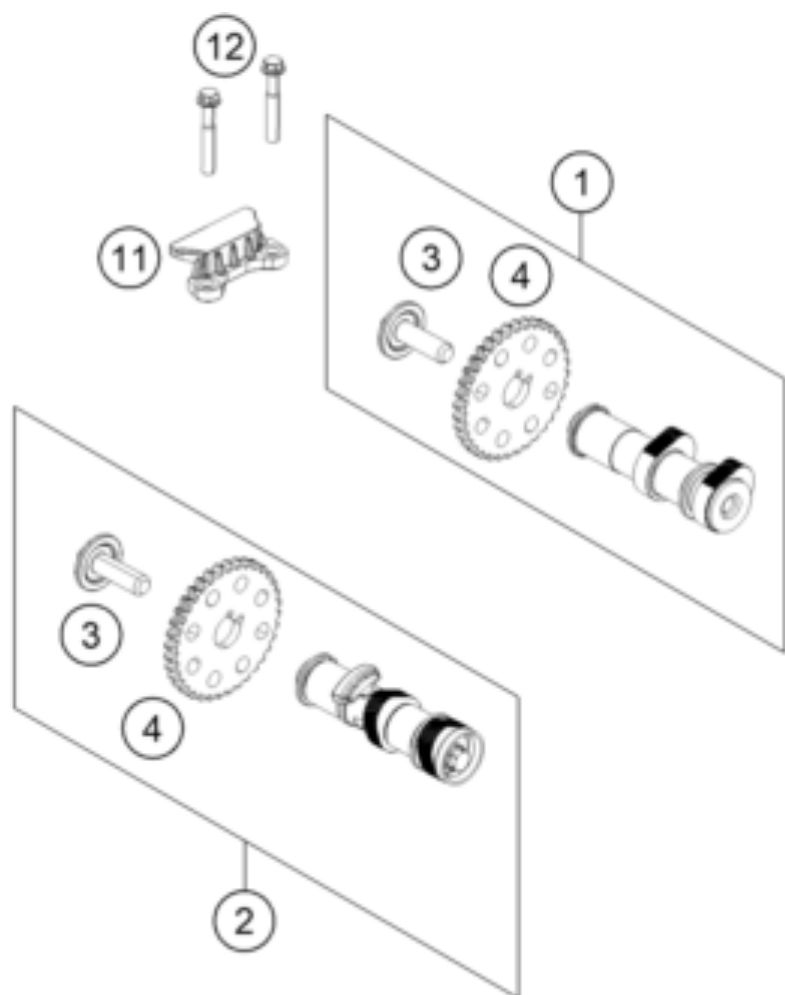

| Pos | Part Number | Description                | Additional Text | Quantity |
|-----|-------------|----------------------------|-----------------|----------|
| 1   | 90236009033 | CAMSHAFT INTAKE CPL.       |                 | 1.00     |
| 2   | 90236010033 | CAMSHAFT EXHAUST CPL.      |                 | 1.00     |
| 3   | 90236037000 | SCREW CAMSHAFT SPROCKET    |                 | 2.00     |
| 4   | 90236009003 | SPROCKET CAMSHAFT          |                 | 2.00     |
| 11  | 90236018000 | CHAIN GUIDE TOP            |                 | 1.00     |
| 12  | J025060401  | HH COLLAR SCREW M6X40      |                 | 2.00     |
| 13  | 90236001000 | TIMING CHAIN GUIDE         |                 | 1.00     |
| 14  | 90236013000 | TIMING CHAIN               |                 | 1.00     |
| 15  | 90236002000 | TENSIONER RAIL CPL.        |                 | 1.00     |
| 16  | 90236002004 | SCREW TENSIONER RAIL       |                 | 1.00     |
| 17  | 90136003003 | GASKET CHAIN ADJUSTER      |                 | 1.00     |
| 18  | J770010015  | O-RING 10,15X1,5           |                 | 1.00     |
| 19  | 90236003044 | CHAIN ADJUSTER             |                 | 1.00     |
| 20  | J025060206  | HH COLLAR SCREW M6X20 SW10 |                 | 2.00     |
| 21  | 90136003002 | SPECIAL SCREW 6X6          |                 | 1.00     |