

# ENTHALTEN IM DICHTUNGSSATZ KPL.  
INCLUDED IN GASKET SET CPL.  
600.30.099.000

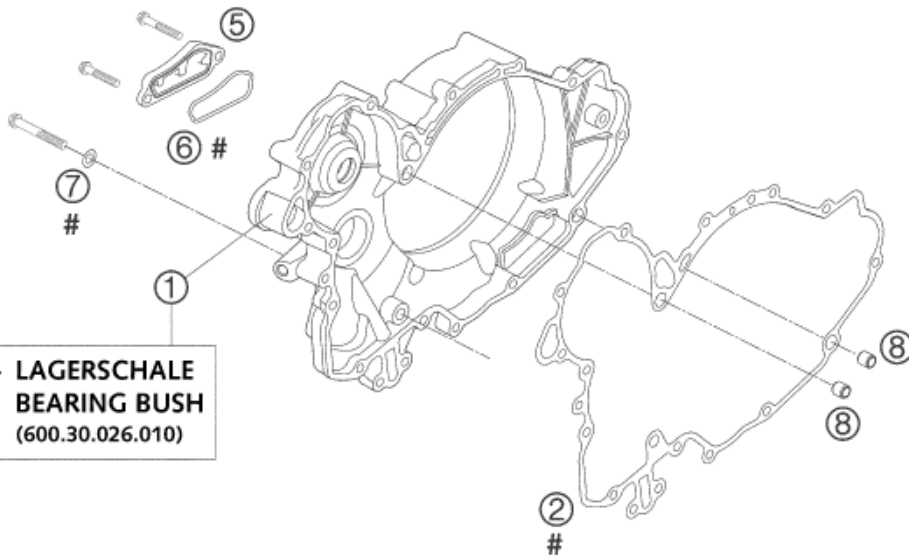

+ LAGERSCHALE  
BEARING BUSH  
(600.30.026.010)

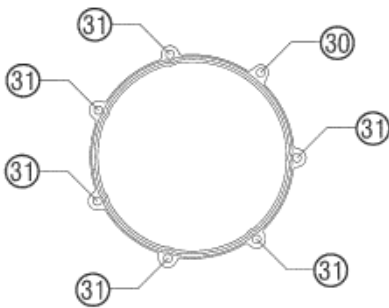

| Pos | Part Number | Description                    | Additional Text | Quantity |
|-----|-------------|--------------------------------|-----------------|----------|
| 1   | 60030001044 | CLUTCH COVER LC8 CPL. 03       |                 | 1.00     |
| 2   | 60030025000 | CLUT.COV. GASK. INSIDE KLI.SIL |                 | 1.00     |
| 3   | 60030026000 | CLUTCH COVER OUTSIDE 27,6MM    |                 | 1.00     |
| 4   | 60030027000 | GASKET RING CLUTCH 2X3,1 VAMAC |                 | 1.00     |
| 5   | 60030012100 | CLOS. COVER OIL SCR. MILLED 03 |                 | 1.00     |
| 6   | 60030012050 | MOLDED RING 1,8X2,5 VAMAC 03   |                 | 1.00     |
| 7   | 0603082131  | COPPER Gask.DIN7603- 8.2X13X1  |                 | 1.00     |
| 8   | 49030090000 | DOWEL 9,8 X 7 X 10             | FS-E            | 2.00     |
| 30  | 0015060853  | HH COLLAR SCREW M 6X85 WS=8    |                 | 1.00     |
| 31  | 0015060253  | HH COLLAR SCREW M 6X25 WS=8    |                 | 6.00     |

|    |            |                              |                   |      |
|----|------------|------------------------------|-------------------|------|
| 32 | 0015060303 | HH COLLAR SCREW M 6X30 SW=8  | LC4, LC4 SM, DUKE | 9.00 |
| 33 | 0015060353 | HH COLLAR SCREW M 6X35 WS=8  | LC4 ADVENTURE     | 2.00 |
| 34 | 0015060403 | HH COLLAR SCREW M 6X40 WS=8  | 450 SMR           | 1.00 |
| 35 | 0015060603 | HH COLLAR SCREW M 6X60 WS=8  |                   | 4.00 |
| 36 | 0015080603 | HH COLLAR SCREW M 8X60 WS=10 |                   | 1.00 |