

DICHTSATZ MOTOR KPL.
ENTHÄLT DICHTSATZ ZYLINDER+KOPF VORNE+HINTEN
GASKET-SET ENGINE CPL.
INCL. GASKET-SET CYLINDER+HEAD FRONT+REAR

Dichtungssatz Zylinder
Gasket-Set Cylinder

Teile mit
Parts with #8

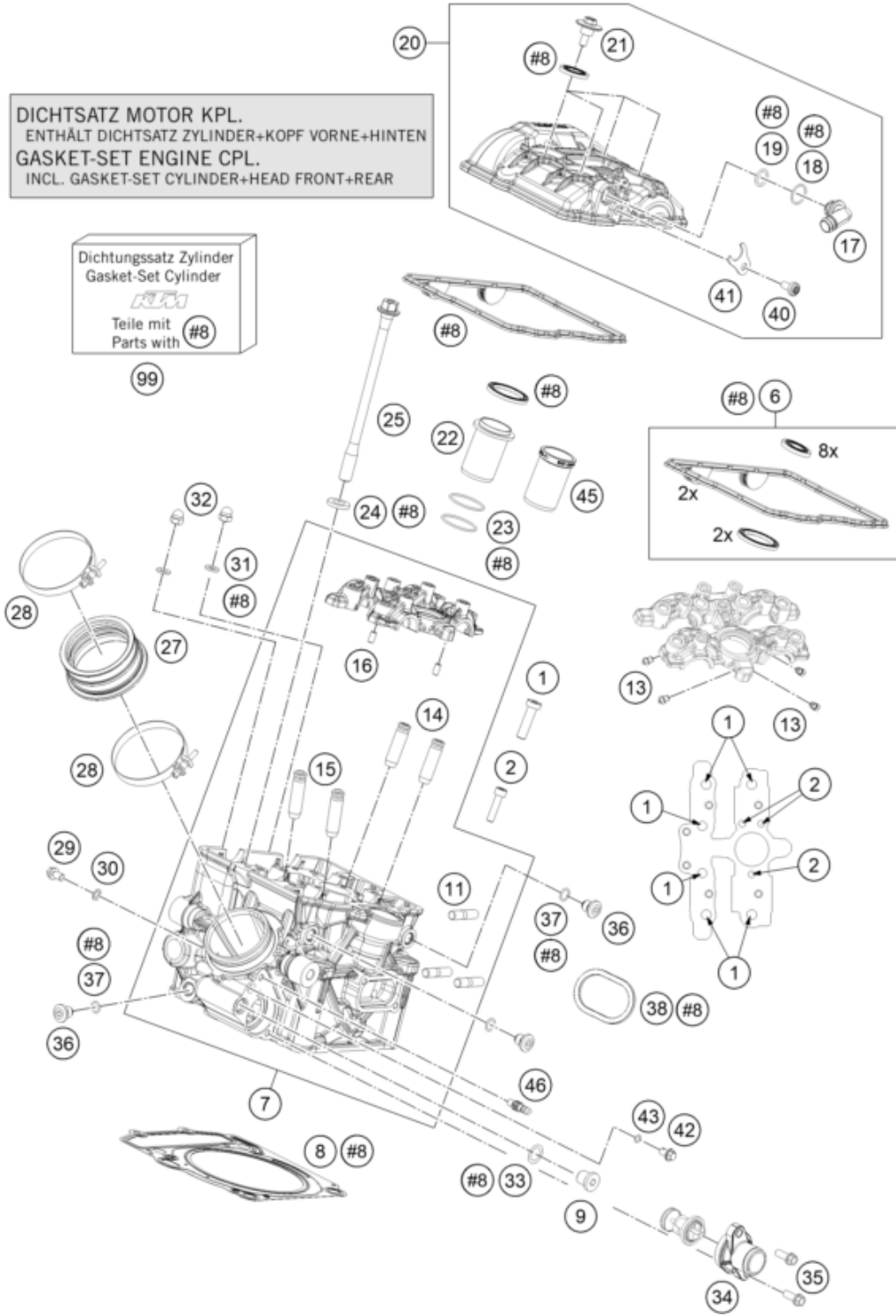

| Pos | Part Number | Description | Additional Text | Quantity |
|-----|---------------|-------------------------------|-----------------|----------|
| 1 | 0984080305 | AH SCREW DIN7984-M 8X30 10.9 | | 6.00 |
| 2 | 0912060255 | AH SCREW DIN0912-M 6X25 10.9 | | 3.00 |
| 6 | 61236099100 | VALVE COVER GASKET SET | | 1.00 |
| 7 | 6043612000024 | CYLINDER HEAD REAR CPL. | | 1.00 |
| 8 | 61330036085 | CYLINDER HEAD GASKET 0,85 | | 1.00 |
| 9 | 0908120153 | threaded plug DIN 908 M12x1.5 | DUKE | 1.00 |
| 11 | 0835080165 | STUD M 8X16 10.9 | | 3.00 |
| 13 | 60030063050 | oil jet 50 M5 | | 4.00 |
| 14 | 61236026001 | VALVE GUIDE EXHAUST 08 | | 2.00 |
| 15 | 61236025001 | VALVE GIUDE INTAKE 6MM | | 2.00 |

| | | | |
|----|---------------|--------------------------------|------|
| 16 | 0402050980 | needle roller DIN 5402 5x9.8 | 2.00 |
| 17 | 61236082100 | CONNECTING ANGLE | 1.00 |
| 18 | 0770150151 | O-RING 15,00X1,50 VITON | 1.00 |
| 19 | 0770120020 | O-RING 12,00X2,00 NBR 70 | 1.00 |
| 20 | 6123615214433 | VALVE COVER REAR | 1.00 |
| 21 | 60036052020 | collar screw M 6 WS=10 03 | 4.00 |
| 22 | 61336075100 | SPARK PLUG SHAFT | 1.00 |
| 23 | 0770298178 | O-RING 29,87X1,78 VITON | 2.00 |
| 24 | 61236079050 | WASHER 11,1X20X3 08 | 4.00 |
| 25 | 61236079000 | CYLINDER HEAD SCREW 08 | 4.00 |
| 27 | 61336044000 | INTAKE BOOT | 1.00 |
| 28 | 61336048000 | HOSE CLAMP GEMI 75 | 2.00 |
| 29 | 0025060106 | HH collar screw M6x10 TX30 | 1.00 |
| 30 | 0603061001 | CU-SEAL RING DIN7603-6X10X1 | 1.00 |
| 31 | 0125060003 | WASHER DIN0125-A 6,4 | 2.00 |
| 32 | 61230045000 | CAP NUT M6 STAINLESS STEEL | 2.00 |
| 33 | 58038022000 | CU-seal ring DIN7603-12X18X1.5 | 1.00 |
| 34 | 61235019100 | WATER CONNECTION CPL. | 1.00 |
| 35 | 0025060206 | HH collar screw M6x20 TX30 | 2.00 |
| 36 | 77336056095 | SCREW PLUG | 3.00 |
| 37 | 07700900151 | O-RING 9x1,5 V80 SH | 3.00 |
| 38 | 69005005100 | EXHAUST PIPE FLANGE GASKET | 1.00 |
| 40 | 0080060123 | EJOT ALtracs 60x12 TX30 | 1.00 |
| 41 | 61236082150 | connecting angle retaining pla | 1.00 |
| 42 | 59036006090 | VENT SCREW M6X10 CPL. | 1.00 |
| 43 | 0770050012 | O-RING 5,0X1,2 NBR 70 | 1.00 |
| 45 | 61336074100 | INSERT SPARK-PLUG SHAFT | 1.00 |
| 46 | 60036023200 | VACUUM CONNECTION M6/0.75MM | 1.00 |
| 99 | 61330097000 | GASKET SET CYLINDER+HEAD F+R | 1.00 |