

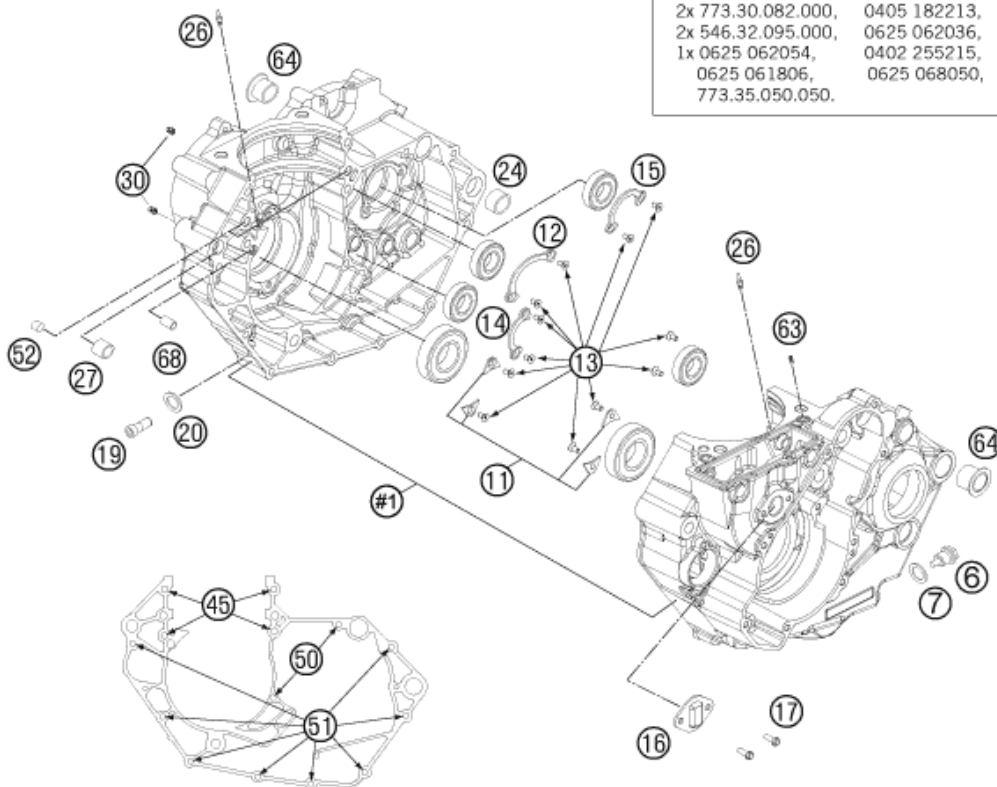

- |    |    |    |    |    |    |    |    |
|----|----|----|----|----|----|----|----|
| #1 | 11 | 12 | 13 | 14 | 15 | 19 | 20 |
| 24 | 26 | 27 | 30 | 52 | 63 | 64 | 68 |
- 12x 0019 050103  
7x 590.30.196.000  
2x 0015 060553  
2x 0912 050123  
1x 773.34.028.000  
1x 773.38.061.000  
1x 773.38.061.050
- + WELLENDICHRINGE / SEAL RING**
- 2x 0760 405560,  
1x 0760 354771,      0760 142460
- + LAGER / BEARINGS**
- 2x 773.30.082.000,      0405 182213,  
2x 546.32.095.000,      0625 062036,  
1x 0625 062054,      0402 255215,  
0625 061806,      0625 068050,  
773.35.050.050.



Pos	Part Number	Description	Additional Text	Quantity
1	77330000244	ENGINE CASE CPL. W.TR.BEAR. 08		1.00
6	58030021000	OILDRAIN PLUG W.MAG. M 12X1,5		1.00
7	58038022000	CU-seal ring DIN7603-12X18X1.5		1.00
11	77330085000	BUSHING RETAINING PLATE		4.00
12	77333022100	BUSHING RETAINING PLATE		1.00
13	0019050103	INT TORX FLAT HEAD M 5X10 8.8		12.00
14	77334090000	BUSHING RETAINING PLATE		1.00
15	77333024100	BUSHING RETAINING PLATE		1.00
16	77336075050	RETAINING PLATE		1.00
17	0025050106	HH collar screw M5x10 TX30		2.00
19	0012080203	AH SCREW DIN6912-M 8X20		1.00
20	0603082121	SEAL RING CU DIN7603- 8X12X1		1.00
24	59030024000	DOWEL 17 X 19 X 12		1.00
26	60030063050	oil jet 50 M5		2.00
27	54630027000	DOWEL BUSHING 13,8X11X12		1.00
30	59030058000	JET 100 BING(44-031/180) M4		2.00

45	77330067170	SCREW M7-1,0X70		4.00
50	0025060706	HH COLLAR SCREW M6X70 TX30		2.00
51	0025060556	HH collar screw M6x55 TX30		8.00
52	0402080120	CYLINDER ROLLER ZRO. 8,0X12 M4		2.00
60	77330099000	GASKET SET 450/505 SX-F		1.00
63	77338029052	THROTTLE M5X10X1		1.00
64	75030010000	CASE BUSH		2.00
68	59030023000	dowel sleeve 6x8x11.5		1.00