

**▲ ACHTUNG !!!**  
 Vor dem Einbau des Vergasers, Bedüsung kontrollieren.  
**CAUTION !!!**  
 Before mounting the carburetor, check the jetting.

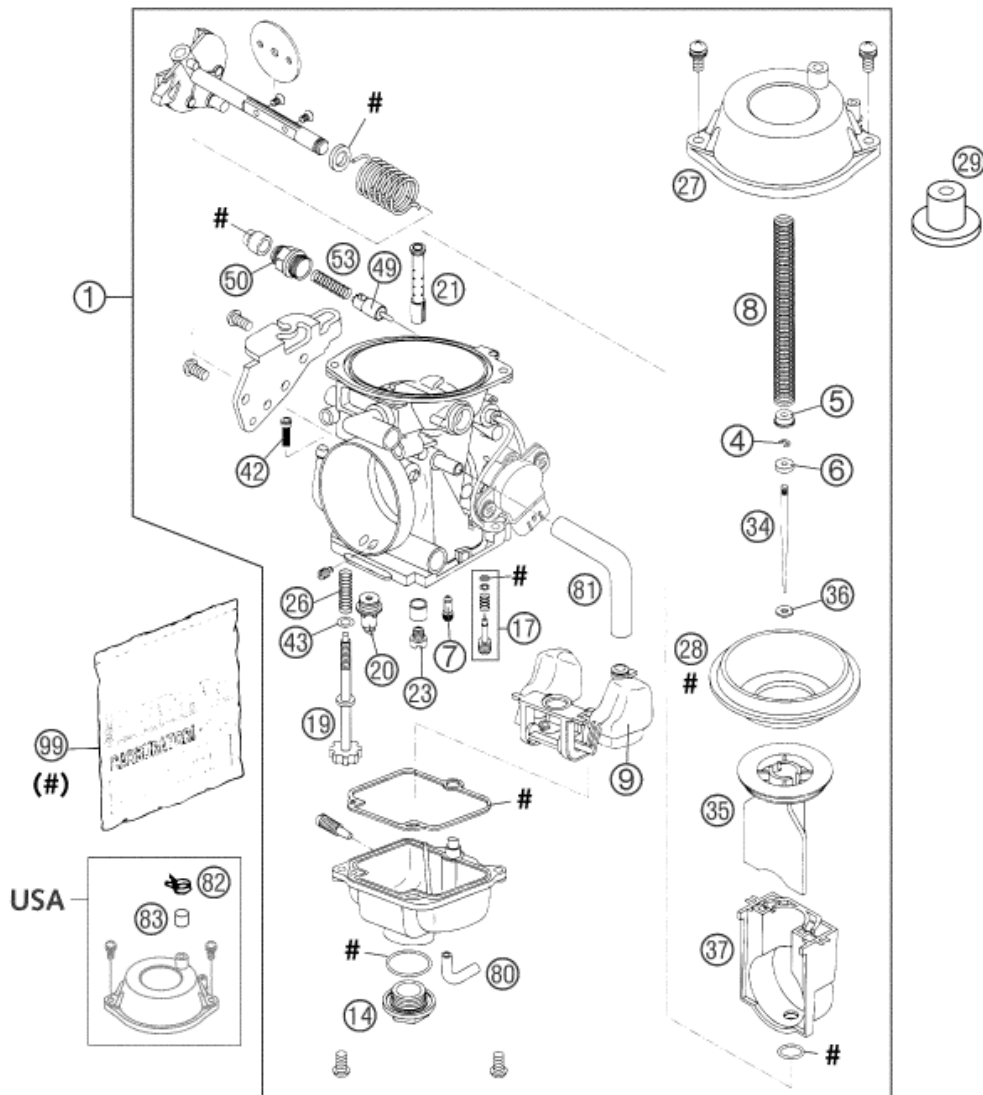

| Pos | Part Number | Description                    | Additional Text | Quantity |
|-----|-------------|--------------------------------|-----------------|----------|
| 1*  | 58431001600 | CARBURETOR MIKUNI BST40-266 03 |                 | 1.00     |
| 4   | 58431045000 | CIRCLIP                        |                 | 1.00     |
| 5   | 58431031000 | SPRING RING                    |                 | 1.00     |
| 6   | 58431032000 | PLASTIC RING                   |                 | 1.00     |
| 7   | 58431007045 | IDLING JET 45                  |                 | 1.00     |
| 7   | 58431007047 | IDLING GET 47,5                |                 | 0.00     |
| 8   | 58431030000 | THROTTLE VALVE SPRING          |                 | 1.00     |
| 9   | 58431009000 | FLOAT 6,1 GRAMM MIKUNI         |                 | 1.00     |
| 14  | 58431014000 | SCREW PLUG FLOAT CHAMBER       |                 | 1.00     |
| 17* | 58431017000 | ADJUST SCREW CPL.              |                 | 1.00     |
| 19* | 58431019000 | ADJUSTER IDLING SPEED          |                 | 1.00     |
| 20  | 58431020000 | NEEDLE VALVE 2,8MM             |                 | 1.00     |
| 21  | 58431021689 | NEEDLE JET 689 X-6             |                 | 1.00     |
| 23  | 58431023140 | MAIN JET 140                   |                 | 0.00     |

|     |             |                                |                   |      |
|-----|-------------|--------------------------------|-------------------|------|
| 23  | 58431023142 | MAIN JET 142,5                 |                   | 0.00 |
| 23  | 58431023145 | MAIN JET 145                   |                   | 0.00 |
| 23  | 58431023147 | MAIN JET 147,5                 |                   | 0.00 |
| 23  | 58431023150 | MAIN JET 150                   |                   | 0.00 |
| 23  | 58431023152 | MAIN JET 152,5                 | ENDURO, ADVENTURE | 1.00 |
| 23  | 58431023155 | MAIN JET 155                   |                   | 0.00 |
| 23  | 58431023157 | MAIN JET 157,5                 |                   | 0.00 |
| 23  | 58431023160 | MAIN JET 160                   |                   | 0.00 |
| 23  | 58431023162 | MAIN JET 162,5                 |                   | 0.00 |
| 23  | 58431023165 | MAIN JET 165                   | SUPERMOTO, DUKE   | 0.00 |
| 23  | 58431023167 | MAIN JET 167,5                 |                   | 0.00 |
| 23  | 58431023170 | MAIN JET 170                   |                   | 0.00 |
| 23  | 58431023172 | MAIN JET 172,5                 |                   | 0.00 |
| 23  | 58431023175 | MAIN JET 175                   |                   | 0.00 |
| 23  | 58431023177 | MAIN JET 177,5                 |                   | 0.00 |
| 23  | 58431023180 | MAIN JET 180                   |                   | 0.00 |
| 26* | 58431026000 | SPRING FOR ADJUSTER            |                   | 1.00 |
| 27  | 58431027000 | DIAPHRAGM COVER MIKUNI         |                   | 1.00 |
| 28  | 58431028000 | DIAPHRAGM FOR THROTTLE VALVE   |                   | 1.00 |
| 29  | 58331029017 | SLIDE STOP L=17MM MIKUNI       |                   | 0.00 |
| 34  | 584310346G5 | JET NEEDLE 6G5                 |                   | 1.00 |
| 35  | 58431035000 | THROTTLE VALVE "1"             |                   | 1.00 |
| 36  | 58431132000 | SHIM JET NEEDLE                |                   | 1.00 |
| 37  | 58431037000 | THROTTLE VALVE GUIDE PLASTIC   |                   | 1.00 |
| 42  | 58431042000 | FUEL SCREEN MIKUNI             |                   | 1.00 |
| 43* | 58431043000 | PACKING RING FOR ADJUSTER      |                   | 1.00 |
| 49  | 58431049000 | STARTING PISTON MIKUNI         |                   | 1.00 |
| 50  | 58431050000 | SCREW M12 STARTSYSTEMN         |                   | 1.00 |
| 53  | 58431053000 | SPRING 22,5MM FOR START.PISTON |                   | 1.00 |
| 80  | 52031137001 | PVC-HOSE 3X5MM                 |                   | 0.50 |
| 81  | 54435024001 | HOSE ID 7,5 PER METER          | FOR 12 LITER TANK | 0.50 |
| 82  | 58031005000 | CLAMP YDNAC 10128 12MM         | FOR 12 LITER TANK | 1.00 |
| 83  | 57931001010 | PLUG CAP FOR EPC CONNECTION    |                   | 1.00 |
| 99  | 58431099000 | GASKET SET MIKUNI BST40-225    |                   | 1.00 |

\* = New part