

# ENTHALTEN IM DICHTSATZ MOTOR LC4  
INCLUDED IN GASKET-SET ENGINE LC4

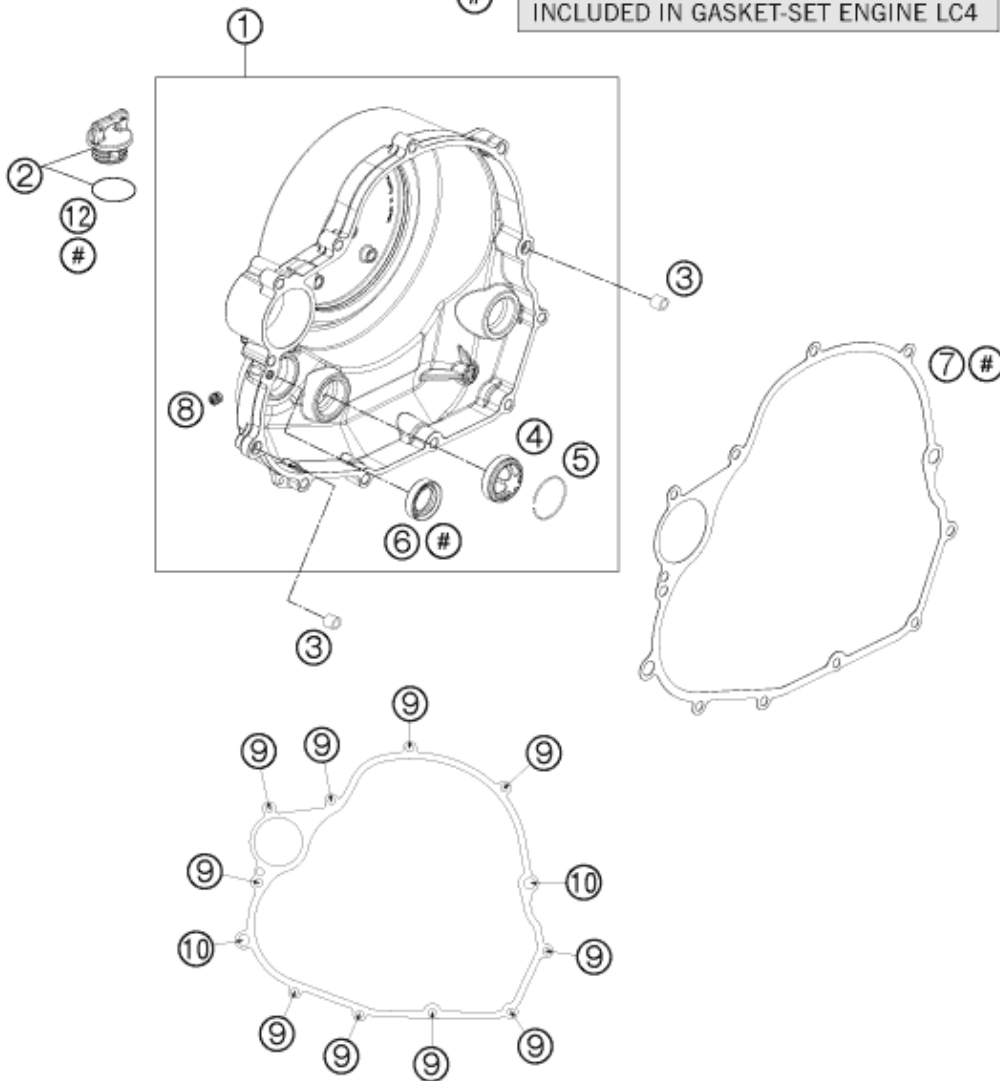

| Pos | Part Number | Description                    | Additional Text | Quantity |
|-----|-------------|--------------------------------|-----------------|----------|
| 1   | 75030001044 | CLUTCH COVER CPL. 07           |                 | 1.00     |
| 2   | 58030020100 | oil plug cpl. M24x3            |                 | 1.00     |
| 3   | 49030090000 | DOWEL 9,8 X 7 X 10             | FS-E            | 2.00     |
| 4   | 59030019200 | OIL SIGHT GLASS                |                 | 1.00     |
| 5   | 61030019050 | CIRCLIP OIL LEVEL GLASS 03     |                 | 1.00     |
| 6   | 0760172871  | SHAFT SEAL RING 17X28X7B VITON |                 | 1.00     |
| 7   | 75030025000 | CLUTCH CASE GASKET 07          |                 | 1.00     |
| 8   | 59030296000 | SCREW PLUG                     |                 | 1.00     |
| 9   | 0025060256  | HH collar screw M6x25 TX30     |                 | 9.00     |
| 10  | 0025060306  | HH collar screw M6x30 TX30     |                 | 2.00     |
| 12  | 0770191015  | O-RING 19,00X3,00 NBR          |                 | 1.00     |